

FRANCE • GERMANY • PORTUGAL



**Self-drive boating holidays**  
*No experience needed!*

**2017**



FRANCE - Bretagne - Josselin  
© CRTB Emmanuel Berthier



All our boats are made in our shipyard in France.



+ 30 years of boating holidays experience.



Smart and bright house boats.



Family friendly boats where safety is paramount.



Small bases with knowledgeable and friendly staff

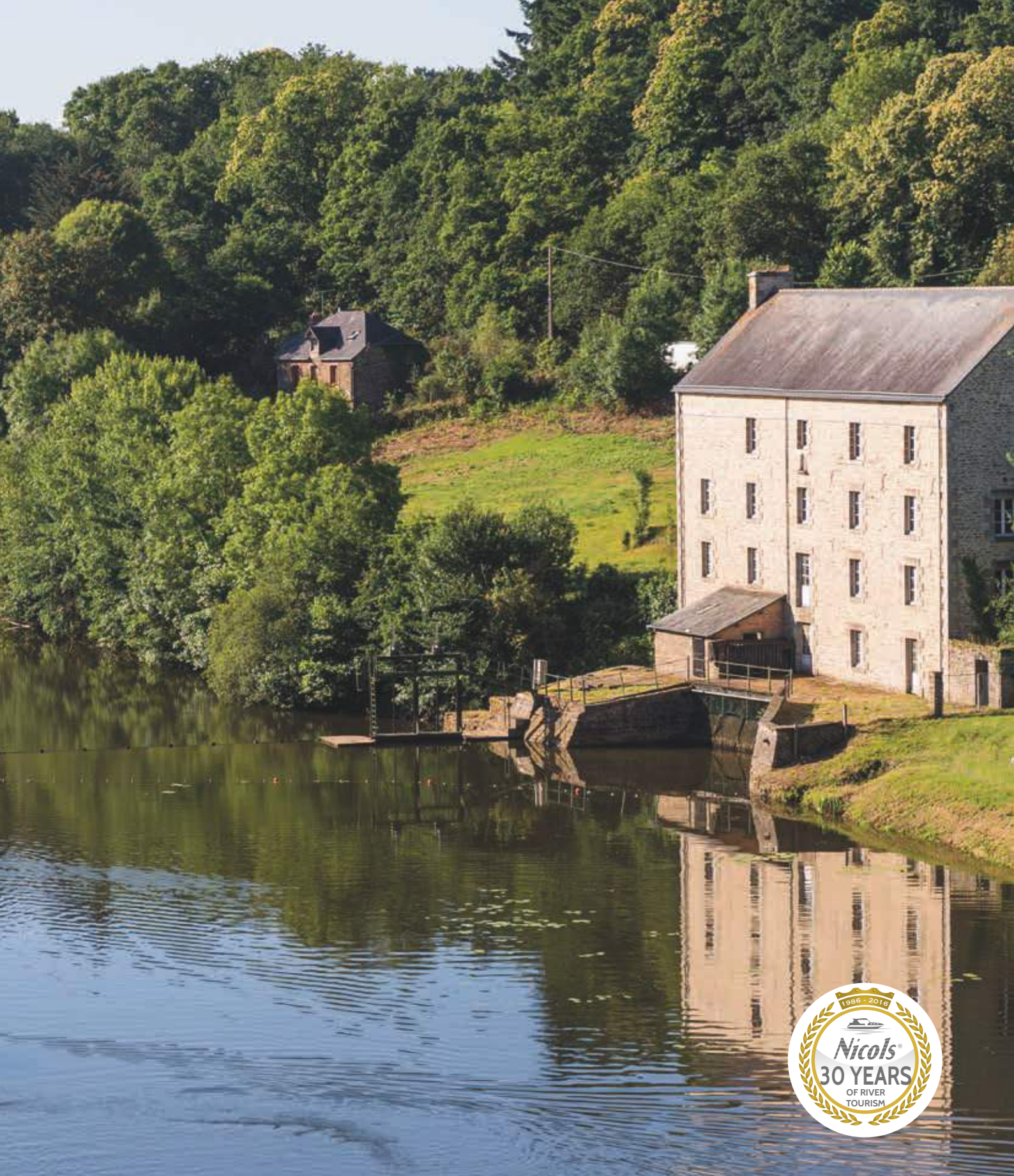

Cruising itineraries on the most beautiful waterways in France, Germany and Portugal (exclusive to NICOLS®).



Excellent savings for our loyal customers.



A welcome present waiting for you on arrival aboard.



And lastly...our heated pool (exclusive to NICOLS®) perfect for children... and for adults!



FRANCE - Bretagne - Josselin



PORTUGAL - Lago Alqueva



PORTUGAL - Monsafaz



ALLEMAGNE - Neuruppin



ALLEMAGNE - Berlin

# Summary



## ▶ Info p.6 to 11

- 6 GET READY FOR YOUR CRUISE
- 8 EVEN MORE TO ENJOY...
- 10 ENVIRONMENT
- 10 NICOLS® VOUCHERS
- 11 THEMED CRUISES

## ▶ France p.12 to 32

- 12 BRITTANY
- 14 ANJOU
- 16 CHARENTE
- 18 LOT
- 20 AQUITAINE
- 22 MIDI
- 24 CAMARGUE
- 26 LOIRE-VALLEY, NIVERNAIS
- 28 BURGUNDY
- 30 FRANCHE COMTÉ, SAÔNE
- 32 ALSACE

## ▶ Germany p.34 to 37

- 34 MECKLENBURG
- 36 BRANDENBURG

## ▶ Portugal p.38-39

- 38 LAGO ALQUEVA

## ▶ Our boats p.40-41

- 40 THE NICOLS® STORY  
OWN YOUR OWN NICOLS® BOAT!
- 41 THE NICOLS FLEET

## ▶ Prices

CAN BE FOUND IN THE CENTRE  
OF THE BROCHURE

▶ Edition 2017 | Photos

© CRTB - Emmanuel Berthier | © A. S. Latry | © Abbaye de Fontenay | © Alessandro Gui | © Andreas-Duerst | © Angers Loire Tourisme | © Anjou Navigation | © Aquitaine Navigation | © Atelier Bos | © B. Liegeois | © Bulle Communication | © CDT Charente | © Charente Tourisme | © Coteaux du Languedoc | © CP M.Bricard | © CRT Centre Val de Loire | © CRT Franche Comté - C. Ambacher | © CRT Franche Comté - J. Thiebaud | © CRT Franche Comté - M. Joly | © CRT Franche-Comté | © CRT Midi Pyrénées - Dominique Viet | © CRT Val de Loire - C. Lazi | © CRTA Zvardon | © CRTB - Emmanuel Berthier | © Denis Gliksmann | © Drone images solutions | © F. Charel | © France Mag / Howorth | © Fusion Libre | © G. Mulvaney | © Gaia - Office de Tourisme de Saintes | © Golf de Cognac | © Golf de Sablé-Solesmes | © Groupe Salins | © Heidi Goertl | © Heinz Storrer | © J. Lepourcelet | © J.J. Bernier | © J.P. Gratien | © Joël Gesvres | © Jörn-Lehmann | © Jose Miguel Redondo | © Lamotte | © M. Hellard | © Magazin Seenland/Weiß | © Malzy | © Messerschmidt-Joachim | © Nicols | © O. Maynard | © OT du Cap d'Agde / Comte | © OT M. Hellard | © P. Sahuquet | © Paloma Mielcarek | © Patrick Moreau | © Ph Sylvain Roussillon | © Pierre Steffen | © Pomet-Nicols | © Régine Datin | © Resort Mark Brandenburg | © Sara Bosmans | © Sarreguemines Tourisme | © Scherer | © Sébastien Laval | © Seth Golub | © Stéphane Ouzounoff | © T. Martrou - CRT Centre-Val de Loire | © Tourist Info Plau am See GmbH-Hendrik Silbermann | © Vallée de la Sarthe | © Ville d'Auxerre - J. Laliaux | © Ville de Dole | © Ville de Laval | © Ville du Mans-G. Mousse | © Virginie Sallé Seutin | © Voyage à Nantes | © Wito GmbH | © Yves Van Cauter | Fotolia | alfotokunst | Fotolia | babelberger | Fotolia | elxneize | Fotolia | fred34560 | Fotolia | JAG IMAGES | Fotolia | Leonid Andronov | Fotolia | P. Bosseboeuf | Fotolia | Pat on Stock | Fotolia | Philphoto | Fotolia | seb hovaguirman | Fotolia | Striker | Fotolia | Studio Photo AG | Fotolia | westfotos | Fotolia | Westfotos de | Fotolia | Julien Leblay



## Get ready for your cruise and... enjoy the water

### ▶ Navigation is easy!

Our boats are easy to operate with either just one inside steering position or a second rooftop position to navigate under the sun with a panoramic view.

You will discover **simple controls that are easy to use**: the wheel, a gear lever and a few instruments on the dashboard. Don't worry if you've never been on a boat before - we'll show you everything you need to know before you set off. You'll be taken out on the water and given a hands on demonstration of everything from how to go through locks to tying up at the water's edge.

**Warning:** the minimum age to take the helm of a boat is 16 years old but they must remain under the captain's (an adult!) responsibility.

### ▶ Where to stop

During your cruise you're free to stop wherever you like...being careful not to disrupt the countryside and wildlife (or encroach on private property!) simply moor up and step ashore.

Day-by-day you'll discover new surroundings and sights as you travel at your own pace through beautiful countryside - a wonderful way to enjoy ever-changing scenery and the great outdoors.

If on the other hand you prefer the hustle and bustle of the towns and villages you pass on route then take advantage of the purpose-built ports and mooring sites. Some are free while others are available at a small charge (this varies depending on the size of the boat and whether there are power charging points). We estimate charges to be between 10€ to 50€. These comfortable and serviced areas will provide easy access to the town.



ways!

## ▶ LOCKS

- **Will I have to pay?** Passage through locks and bridges is free
- **Are they automatic?** Most locks are automatic and operated by a lock keeper who may ask you to help them, whilst others are manual. In the Charente the locks are all operated by you and your crew, thus you are not restricted by timetables.
- **Are there days of closing?** Most locks are automatic and operated by a lock keeper who will be happy to help you. In general, lock keepers do not work on Bank Holidays : **1<sup>st</sup> May, 14<sup>th</sup> July, 1<sup>st</sup> November.** For a list of regions concerned please contact us.



## ▶ Canal or river?

Most of the waterways in our brochure are generally wide and non-tidal making them easy to navigate. Depending on your chosen departure base you may cruise on both canals and rivers.

**Rivers, where natural**, are more susceptible to the possibility of flooding compared to **the manmade canals** - especially in Spring and Autumn.

Some navigation restrictions may occur as a result of this flooding and for your own safety we may change your departure base or restrict cruising to the canal sections only, rather than cancelling your cruise completely. Please make enquiries about the state of the waterways before leaving on your cruise.

**WARNING:** the information provided in this document is not contractual.  
Characteristics may vary depending on the boats and the areas where you'll navigate.

## ▶ Waterways guides

A comprehensive guide is vital for planning your cruise. It provides detailed information of the waterways on which you will navigate highlighting **useful information** such as the location of locks, quays, water fill-up points in addition to **tourist information** such as places to visit and their opening hours, market days, good restaurants and much more.

We recommend you order your waterways guide at the same time as booking so that you receive it with the other cruise documentation you will be sent. This means you will have plenty of time to plan your journey in advance.



## Even more to enjoy...



### ▶ Bicycles

Bikes are available to hire from all of our bases and provide extra flexibility for exploring the area where you've moored, little villages, places of interest or simply for going to buy your daily bread.

*Helmets are recommended for children: please remember to bring your equipment.*



### ▶ Animals

Pets are welcome onboard. A supplement of 40 euros will be requested when you depart the base. Don't forget to bring their belongings (feeding bowl, bedding/blankets etc) and when travelling ensure that they remain safe and cannot cause any harm or damage.



### ▶ Fishing

Your boat is a great vantage point for fishing from. You can fish in the canals and rivers providing you hold a fishing licence.

These can be purchased from local fishing tackle shops or on the web ([www.cartedepeche.fr](http://www.cartedepeche.fr)).

In France: Cost approximately 30 euros and valid for 7 days.

In Portugal : about 25€ for your whole cruise



## ▶ Barbecue

Hire all of the equipment you'll need to enjoy a barbecue, then simply pick up your food fresh from the many mooring places you'll find on route.

Take it on board with you...most of our bases even offer rental of gas bottles. As with all barbecues please be careful and familiarise yourself with all the equipment before departure.



## ▶ WiFi

Whether it's your tablet, laptop or mobile phone... stay connected during your cruise!

Most of our bases offer a Wifi service that will allow you to connect multiple devices simultaneously\*. For more information please contact us.

(\*subject to the quality of network coverage. This varies by region).



## ▶ Your luggage

Holdalls are recommended - they are easy to stow away. Suitcases do take up far more space on board, so perhaps unpack them and leave in the boot of your car. Take with you comfortable non slip shoes so that you can move on the deck without danger (tennis or baskets).

Don't forget sun glasses and sun creams, hats, gloves... and your camera!



## ▶ All inclusive

The Nicols® ALL INCLUSIVE option makes holiday planning easy with everything you need and more for a wonderful boating holiday. Let us do the hard work while you sit back and relax.

The all inclusive option includes: boat fuel + 2 bikes + a waterways guide + cleaning fee + towels + kitchen linen. For more information please contact us.

## ▶ The swimming pool: a Nicols® exclusive



The on-board pool! Discover the pleasures of on-board bathing by adding one of our fantastic heated splash pools - simply tow it along with your boat. Suitable for the Estivale, Confort and Sedan (except N800 and Primo®) ranges.

*N.B. : For the Octo®, Sixto®, N1310, N1350 and VIP a pleasure boat licence is necessary due to the total length of the boat plus pool.*

### TECHNICAL DESCRIPTION:

Dimensions: 2,55 m x 3,10 m. Capacity: 700 litres, suitable for 3 people. Terrace with double safety rails. Converts into a larger terrace with two sliding covers.

Available in: **Alsace, Aquitaine, Brittany, Charente, Franche-Comté, Midi.**

**WARNING:** the information provided in this document is not contractual.  
Characteristics may vary depending on the boats and the areas where you'll navigate.

# Let's take care of the environment together!



## Caring for the environment

We take our responsibility for caring for the environment very seriously and are continuously striving to implement best practice procedures. To help you do your bit, on the day of departure Nicols® will provide you with a welcome kit which includes some biodegradable cleaning products for use on your holiday. Rubbish bags should be left in the areas provided.

Please abide by the strict speed limits to reduce bankside erosion and protect the wildlife that live there and when mooring, be careful not to damage the plants around you.

Our aim is to ensure that our boats and everyone who uses them have a minimal impact on the environment to protect our waterways so many more people can enjoy them for years to come.



© Sara Bosmans

## ▶ Don't forget our Nicols® vouchers!



Looking for a great gift idea? Treat family or friends to a self drive boating break on one of our Nicols® boats. No previous boating experience needed!

**Contact us for more information.**



# Themed cruises from Nicols®

Got a family and want child-friendly activities?  
Like good restaurants, tasty food and fine wines?  
Or maybe you're a culture vulture preferring a visit to historical monuments and famous sites?

Whatever you're after Nicols® new themed cruises will help you choose the best suited itinerary to match your interests. Lookout for the appropriate symbols flagging the interests throughout the brochure...



## FOOD & WINE:

Vineyards, wineries, tasting venues, restaurants offering prestigious local specialties and local produce tastings...

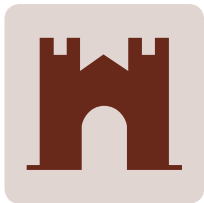

## HISTORY & HERITAGE:

Castles, religious buildings, classified sites, free tours to discover places of interest or hosted tours from the experts...



## NATURE :

Areas of natural beauty for fauna, flora and wildlife. Free tours to discover places of interest or hosted tours from the experts...



## SWIMMING & BATHING:

Natural and artificial lakes, easy beach access close to the river/canal, swimming pools and waterparks...

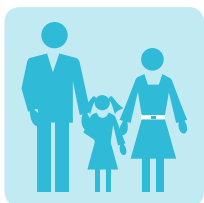

## FAMILY:

Highlights any route with activities suitable for children and the whole family to enjoy. Zoo's, play areas, adventure parks and many more...



## Index of map icons (p. 12 to 39)

	Train station
	Airport
	Historical heritage
	Religious heritage
	Museum
	Typical town centre
	Craft industry
	Archaeological site
	Restaurant
	Vineyard area
	Boat lift Water slope Lock staircase
	Swimming
	Indoor pool
	Nautic activities
	Fishing
	Marvelous flora & fauna, Zoo, Animal park
	Golf
	Cycle paths
	Pony trekking
	Hiking
	Viewing point





# Bretagne *Brittany*



Canal de Nantes à Brest  
La Vilaine  
L'Erdre

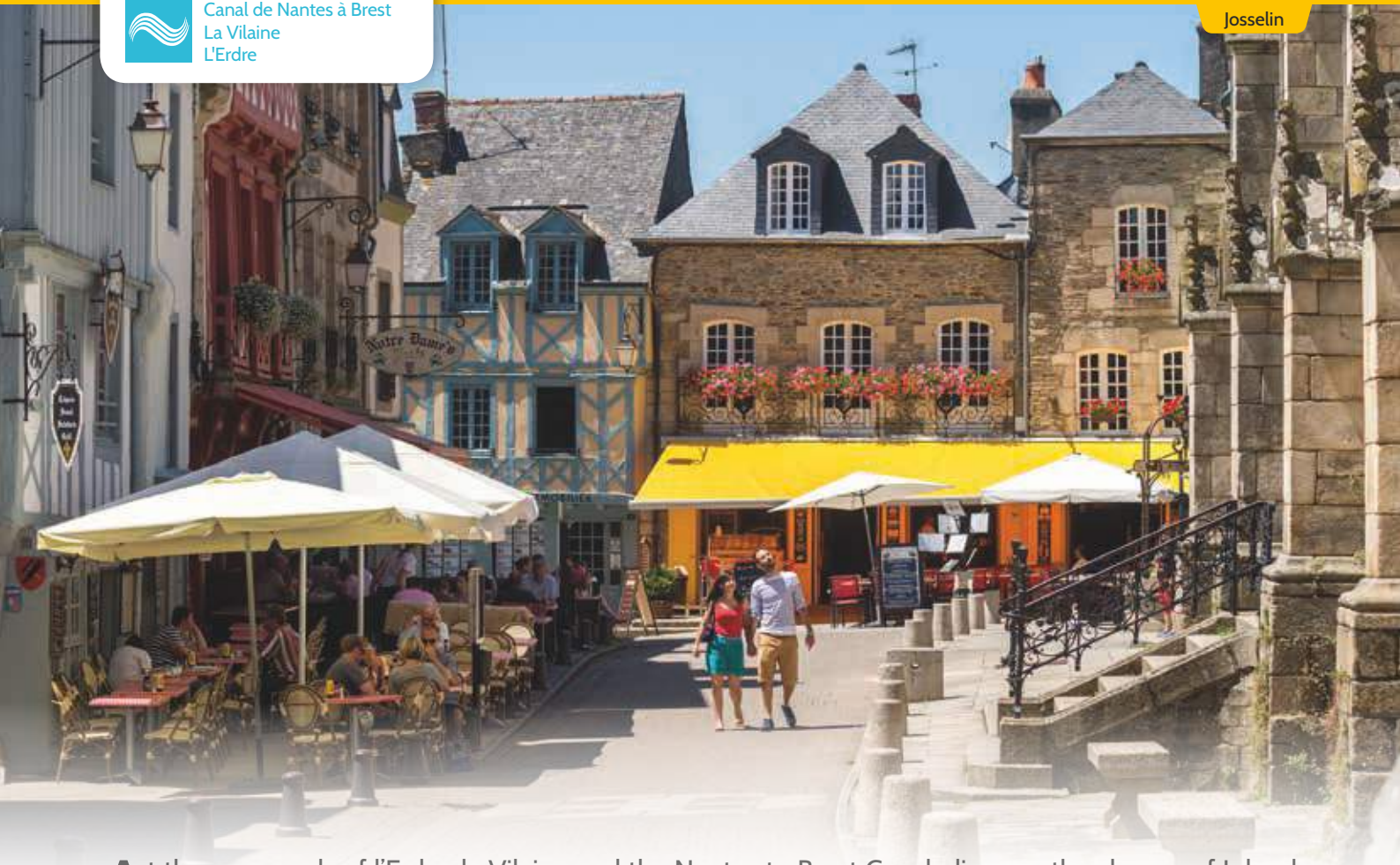

At the crossroads of l'Erdre, la Vilaine and the Nantes to Brest Canal, discover the charms of Inland Brittany: waterways devoted entirely to pleasure cruising, its traditions, its seafood, delicious crepes and traditional cider!



## From Glénac and Sucé-sur-Erdre

Explore a land of magic and mystery, rich in colour and traditions with a boating holiday in Brittany cruising the canal from Nantes to Brest. Enjoy historical treasures and remarkable natural sites: Josselin, with its magnificent castle reflected in the water ; **Malestroit and its 15<sup>th</sup> century houses** ; the craftsman village of Gacilly ; Redon founded in 832 or Blain (traditional popular arts museum).

The river Vilaine takes you to Rennes, the capital of Brittany, and on to Dinan and the surrounded ramparts dating back to the thirteenth century.

Following the Erdre you'll pass fantastic golf courses. Count **17 castles within just 15km of waterways on this stretch!** In two hours of locks free cruising you'll be at the heart of the city of Nantes and all its treasures: Cathedral St Pierre, Chateau des Ducs de Bretagne, Pommeraye passage, Museum of Fine Arts, the Machines of the Isle... to name just a few!





L'Erdre



Canal de Nantes à Brest



Rochefort-en-Terre



- NICOLS® base
- Navigation limit
- Dam
- See p. 11

## GLÉNAC

- Redon (12 km), Rennes (70 km), Nantes (90 km).
- A81 (Paris-Rennes - 350 km).
- TGV Redon (12 km), TGV Rennes (65 km), TGV Nantes (105 km).
- Nantes (105 km), Rennes (71 km).

- ESTIVALE** Duo® | Quattro® | Quattro® S | Sixto® | Octo®
- CONFORT** 900 DP | 1100 | 1350
- SEDAN** 1000 | 1170 | 1310 | Primo®

DURATION	CRUISE	KM	LOCKS	HOURS
2 DAY WEEKEND	A Glénac > Malestroit > Glénac	59	10	10h
	B Glénac > La Roche-Bernard > Glénac	90	2	12h30
	C Glénac > Guenrouët > Glénac	74	4	11h30
SHORT BREAK	A Glénac > Josselin > Glénac	109	30	22h
	B Glénac > Guipry-Messac > Glénac	132	4	18h30
	C Glénac > Blain > Glénac	118	14	21h30
SHORT BREAK (One way)	A Glénac > Sucé/Erdre	93	17	20h30
1 WEEK	A Glénac > Josselin > Rohan > Glénac	158	62	39h
	B Glénac > Rennes > Glénac	184	24	33h
1 WEEK (One way)	A Glénac > Nantes > Sucé/Erdre	136	17	27h
2 WEEKS	A Glénac > Nantes > Sucé/Erdre	136	17	27h
	B Glénac > Nantes > Glénac	238	34	47h

## SUCÉ-SUR-ERDRE

- Nantes (20 km), Rennes (115 km).
- A11 (Paris-Nantes - 380 km). 23 - Nantes-Est.
- Nantes (20 km), TGV Paris-Nantes (2h15).
- Paris-Orly (375 km), Nantes (30 km).

- ESTIVALE** Duo® | Quattro®
- CONFORT** 900 DP
- SEDAN** 1000 | 1170
- RIVIERA** 920

DURATION	CRUISE	KM	LOCKS	HOURS
2 DAY WEEKEND	A Sucé/Erdre > Blain > Sucé/Erdre	70	20	14h
	B Sucé/Erdre > Nantes > Bout de Bois > Sucé/Erdre	76	12	15h
SHORT BREAK	A Sucé/Erdre > Guenrouët > Sucé-sur-Erdre	114	30	23h
SHORT BREAK (One way)	A Sucé/Erdre > Glénac	93	17	20h30
1 WEEK	A Sucé/Erdre > La Gacilly > Sucé/Erdre	194	32	35h
	B Sucé/Erdre > La Roche-Bernard > Sucé/Erdre	228	32	36h
	C Sucé/Erdre > Messac > Sucé/Erdre	240	34	41h
1 WEEK (One way)	A Sucé/Erdre > Nantes > Glénac	136	17	27h
2 WEEKS	A Sucé/Erdre > Redon > Rennes > Sucé/Erdre	334	58	60h
	B Sucé/Erdre > Redon > Josselin > Sucé/Erdre	268	60	55h

Boat and cruising route suggestions: non contractual information, subject to change.



La Mayenne  
La Sarthe  
L'Oudon

# Anjou

La Sarthe



Just a few hours from Paris, discover Anjou. Famous for its gentle atmosphere, excellent gastronomy, its castles and abbeys, rural stopover mooring points and sporting and cultural attractions! This region is also one of the best-equipped networks in France with plenty of mooring ports and easy to use locks with lockkeepers at hand. Here, waterways are entirely devoted to pleasure cruising. You will find relatively few locks (open all year round)... perfect for first time cruisers !



## From Grez-Neuville

Discover the river Mayenne, dotted with **small villages, manor houses, castles and old mills clinging** to the river's hillside. Make a stop at Angers, King René's city, also The Abbey of Port Salut in Entrammes (yes, the home of the famous cheese!). In the town of Laval the Naive Art Museum is worth visiting. The Oudon river near Grez-Neuville will bring you calmness and don't miss the stud farm in the Lion d'Angers.

## From Laval

See more with a one-way cruise from Laval to Sablé-sur-Sarthe or Laval to Grez-Neuville. This route is perfect for nature lovers taking in the high valleys of Anjou (a Natura 2000 nature protection area) with visits to great places such as Laval, Château Gonthier, Angers and Sablé-sur-Sarthe.

## From Sablé-sur-Sarthe

The river Sarthe is a **calm and peaceful river** meandering through verdant countryside dotted with picturesque villages. There are very few locks along its reaches, so it's ideal for beginners. Don't miss **the most elegant castle of plessis Bourré**, the imposing Benedictine Abbey of Solesmes, Malicorne, capital of artistic porcelain and the older part of Le Mans town.



Sablé-Solesmes Golf Course



Sablé-sur-Sarthe



Laval



La Mayenne



Le Mans



Angers

## GREZ-NEUVILLE

Angers (25 km).

A11 (Paris-Angers 300 km) **17** 17.

TGV Angers (25 km).

Paris-Orly (305 km), Nantes-Atlantique (110 km).

<b>ESTIVALE</b>	Duo®   Quattro®
<b>CONFORT</b>	900 DP   1100   1350
<b>SEDAN</b>	1000   Primo®   1170

DURATION	CRUISE	KM	LOCKS	HOURS
2 DAY WEEKEND	A Grez > Château-Gontier > Grez	62	18	10h30
	B Grez > Daon > Segré > Grez	62	12	10h30
	C Grez > Angers > Grez	62	8	10h30
SHORT BREAK	A Grez > Entrammes > Grez	122	34	21h
	B Grez > Château-Gontier > Segré > Grez	96	24	18h
SHORT BREAK (One way)	A Grez > Segré > Laval	106	27	17h30
	B Grez > Montgiroux > Laval	110	35	20h
1 WEEK	A Grez > Laval > Segré > Grez	176	46	30h
	B Grez > Sablé > Malicorne > Grez	190	42	30h
1 WEEK (One way)	A Grez > Segré > Angers > Malicorne > Sablé	175	27	28h
	B Grez > Château-Gontier > Angers > Sablé	144	27	24h

## LAVAL

Paris (280 km), Rennes (75 km).

Rennes : A81, **4** 4, Paris : A11 / A81, **3** 3

TGV 800 m.

Rennes (80 km).

Choose your boat from either the Grez-Neuville or Sablé-sur-Sarthe fleet.

## SABLÉ-SUR-SARTHE

Paris (250 km), Rennes (128 km), Angers (65 km), Le Mans (50 km).

A11 (Paris-Sablé 260 km), **10** 10 (13 km).

Sablé 800 m, TGV Paris-Sablé (1h20).

TGV Roissy CDG-Sablé (2h20), Roissy CDG (285 km), Paris-Orly (250 km), Nantes-Atlantique (160 km).

<b>ESTIVALE</b>	Duo®   Quattro®   Octo®
<b>CONFORT</b>	900 DP   1100   1350
<b>SEDAN</b>	1000   1010   1160   1170   1310   Primo®
<b>RIVIERA</b>	920   1130

DURATION	CRUISE	KM	LOCKS	HOURS
2 DAY WEEKEND	A Sablé > Malicorne > Sablé	52	10	10h
	B Sablé > Château-neuf-s.-Sarthe > Sablé	60	10	10h
SHORT BREAK	A Sablé > Spay > Sablé	120	22	20h
	B Sablé > Angers > Sablé	120	12	18h
1 WEEK	A Sablé > Malicorne > Château-neuf > Sablé	112	20	19h
	B Sablé > Spay > Château-neuf > Sablé	149	26	25h
1 WEEK (One way)	A Sablé > Angers > Grez > Sablé	84	10	14h30
	B Sablé > Malicorne > Angers > Segré > Grez	175	27	28h
1 WEEK (One way)	B Sablé > Angers > Château-Gontier > Grez	144	27	24h
	C Sablé > Angers > Laval	146	31	28h

DURATION	CRUISE	KM	LOCKS	HOURS
SHORT BREAK (One way)	A Laval > Segré > Grez	106	27	17h30
	B Laval > Montgiroux > Grez	110	35	20h
1 WEEK (One way)	A Laval > Angers > Sablé	146	31	28h

**EVEN MORE COMFORT ON BOARD!**

The whole fleet benefit from 1 quay plug 220 Volts and electric toilet.



# Charente

Saint-Simeux



Enjoy a boating holiday on one of France's most beautiful rivers. Take in green countryside, crystal clear waters and fields of sunflowers whilst you cruise. The best bists : Locks operated by yourself so no restrictions on travel time ; Cognac and Pineau vineyards and tasting! Peaceful countryside and ancient Roman sites.



## From Sireuil

Large and winding, the river Charente quoted by François the 1<sup>st</sup> as "the most beautiful stream in the Kingdom", runs through the ancient counties of "Langoumois" and "La Saintonge".

For 171 km, from Angoulême to Rochefort, the Charente is regulated by 21 locks. The ancient vineyards cover the surrounding hills. Many cellars and distilleries will invite you to taste **the famous Cognac or delicious pineau des Charentes**. Along your cruise, you will find many villages and towns that are testimonies to a rich past such as Angoulême, Fleurac, Saint-Simeux, Châteauneuf, Saint-Simon, Bassac, Jarnac, Saint-Brice, Cognac, Saintes, Saint-Savinien, and Rochefort.

In the Charente area, the gastronomy based on seafood and local products, is waiting for you along the river with many of its restaurants preparing local specialities ("mouclade", oysters, melon, meats, snails, cheese...). Fishermen will not be forgotten and will find plenty of brown trout, carp, pike, perche, and eels...



Saintes - Amphitheater







Rochefort - Royal Maritime Museum



Cognac



Cognac Golf Course



Angoulême



Saintes

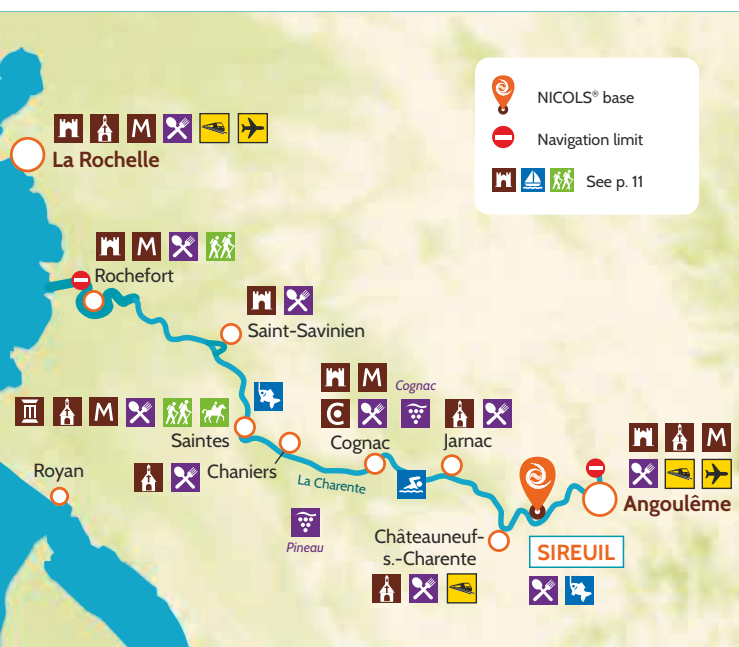

## SIREUIL

- Poitiers (130 km), Bordeaux (118 km), Angoulême (20 km).
- A10 (Paris) **IV** 30 (Poitiers-Sud), A10 (Bordeaux) **IV** 39b (Barbezieux).
- Angoulême (20 km), TGV Paris (2h20), Châteauneuf-s.-Charente (8 km).
- La Rochelle-Laleu (145 km), Bordeaux-Mérignac (118 km), Angoulême-Champniers (30 km).

- ESTIVALE** Duo® | Quattro® | Sixto® | Octo®
- CONFORT** 900 | 900 DP | 1100
- SEDAN** 800 | 1000 | 116ON | Primo®
- RIVIERA** 920
- PISCINE / POOL**

DURATION	CRUISE	KM	LOCKS	HOURS
2 DAY WEEKEND	A Sireuil > Jarnac > Sireuil	56	18	13h
SHORT BREAK	A Sireuil > Chaniers > Sireuil	132	30	24h
1 WEEK	A Sireuil > Saint-Savinien > Sireuil	198	30	32h
2 WEEKS	A Sireuil > Rochefort > Sireuil	252	32	40h



# Lot

Saint-Cirq-Lapopie



From Bouziès-Saint-Cirq-Lapopie: the cliffs of limestone, the picturesque villages, the gastronomy : stuffed foie gras, goose confit, Cahors wine...



## Lot-Quercy, from Bouziès / Saint-Cirq-Lapopie

A succession of **cliffs and caves** await you around the tree-lined curves of the Lot. A 74 km-river for your complete pleasure!

17 manual locks, to operate yourself as in former times. The old villages of Quercy with their narrow alleys and mossy, red roofs, the famous Valentré bridge of Cahors, the cliffs of Bouziès, St-Cirq-Lapopie village overlooking the valley, add to the charm of this navigation.



Bouziès base



Cahors - Valentré bridge



Pech Merle caves



Le Lot



Ganil towpath

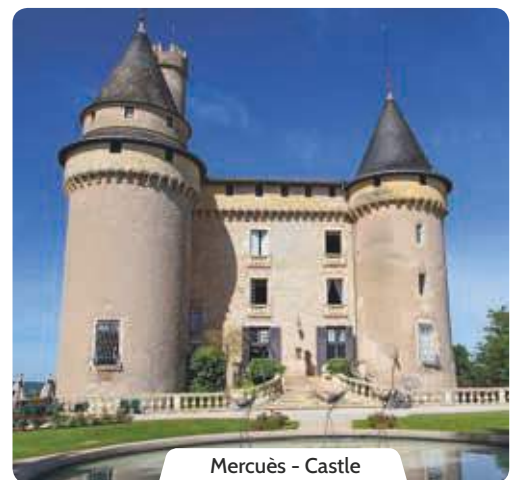

Mercuès - Castle

## BOUZIÈS / SAINT-CIRQ-LAPOPIE

- Cahors (35 km), Montauban (100 km), Brive (110 km), Toulouse (150 km).
- A20, Paris-Toulouse, N17 57 Cahors-Nord (27 km).
- Cahors (35 km).
- Toulouse-Blagnac (150 km).

**ESTIVALE CONFORT**  
**SEDAN**  
**RIVIERA**

Duo® | Quattro® | Octo®  
900 | 900 DP | 1100  
1000 | 1010 | 1170 | Primo®  
920

	DURATION	CRUISE	KM	LOCKS	HOURS
1 WEEK	A	Bouziès > Larnagol / Luzech > Bouziès	146	34	28h
	B	Bouziès > Larnagol > Cahors > Bouziès	88	24	18h

Boat and cruising route suggestions: non contractual information, subject to change.



La Baise  
Canal de Garonne

# Aquitaine

La Baise



From Buzet: possibility to cruise both on canal and river, automatic locks, natural beauty and cultural inheritance, local specialities : Armagnac, duck breast, Agen prunes, Buzet wines...



## Aquitaine, from Buzet

A choice of memorable itineraries in the land of King Henri IV and d'Artagnan the Musketeer!

**The River Baise**, mysterious and bewitching, meandering its way past bastide towns, abbeys and castles of Gascony, visiting Vianne, Nérac and Condom.

**The garonne Canal** flows quietly under the plane trees towards the Aqueduct of Agen, the Cloister of Moissac, "the Water Slope" of Montech and through the historic town of Toulouse.

**Towards Bordeaux**, discover the Rembrandt of Le Mas d'Agenais, the promontory of Meilhan and the charming village of Fontet.

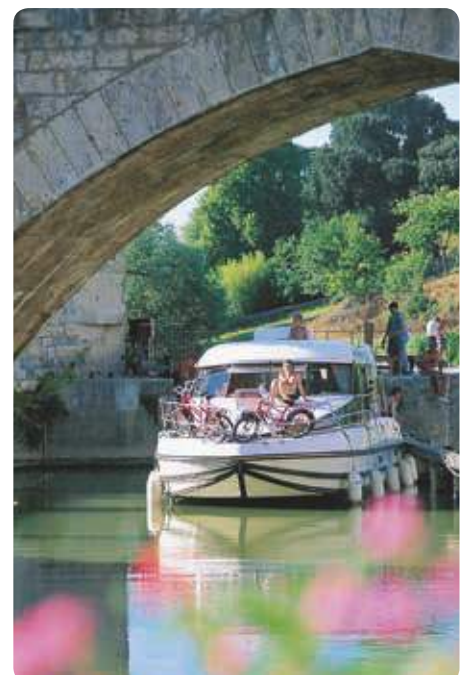



Moissac



Nérac



Condom

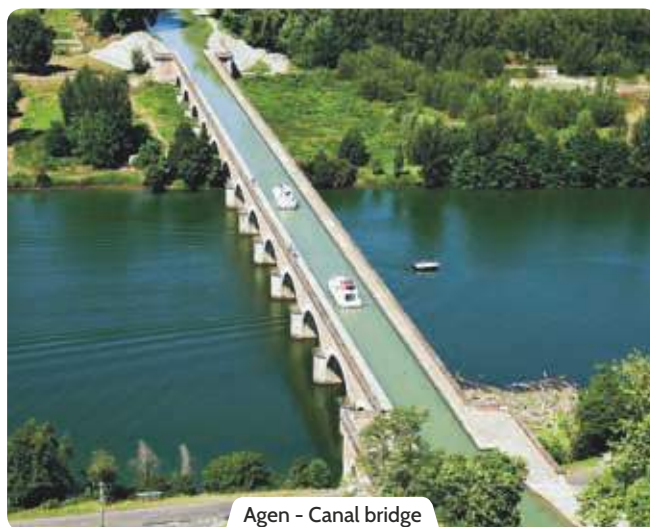

Agen - Canal bridge

## BUZET-SUR-BAÏSE

Bordeaux (110 km), Agen (30 km), Toulouse (150 km).

A62, Bordeaux-Toulouse, 176 Aiguillon (5 km).

Aiguillon (5 km), Agen (30 km), TGV Paris-Agen (4h).

Bordeaux-Mérignac (115 km), Toulouse-Blagnac (150 km).

-  **ESTIVALE** Duo® | Quattro® | Octo®
- CONFORT** 900 | 1100 | 1350
- SEDAN** 1000 | 1010 | Primo®
- RIVIERA** 920 | 1130
- PISCINE / POOL**

DURATION	CRUISE	KM	LOCKS	HOURS
2 DAY	A (Baïse) Buzet > Nérac > Buzet	42	14	10h
	B (Canal) Buzet > Agen > Buzet	56	14	10h
WEEKEND	A (Baïse) Buzet > Moncrabeau > Buzet	70	28	17h
	B (Canal) Buzet > Fontet > Buzet	98	16	17h
	C (Canal) Buzet > Valence d'Agen > Buzet	108	20	18h
SHORT BREAK	A (Baïse) Buzet > Valence-s.-Baïse > Buzet	112	40	28h
	B (Canal) Buzet > Montech > Buzet	184	58	38h
1 WEEK				

Boat and cruising route suggestions: non contractual information, subject to change.



Canal du Midi  
Canal de la Robine  
Canal du Rhône à Sète

# Midi

Carcassonne



Classified by UNESCO as a World Heritage Site, the Canal du Midi links the Atlantic with the Mediterranean and takes you through sun-drenched vineyards and to numerous villages and canal-side restaurants. The best bits: plenty of sunshine, numerous historical sites to visit, and excellent Languedoc wines from waterside vineyards.



## From Le Somail

From the charming small port of Le Somail, cruise away to discover the Canal du Midi in the direction of **Carcassonne** or if your cruising time permits down to Narbonne close to the Mediterranean Sea. You will cruise on the largest pound of France (52 km without any locks) up to the Fonserannes staircase, situated close to the historical city of Béziers.

A few kilometres more and you arrive, via Agde, to the huge Etang de Thau - renowned for its oyster beds...

## From Port-Lauragais

Cast off from our new base in Port-Lauragais and sail west towards **Toulouse**, named the "pink city" because of its red brick buildings, rich with points of interest for tourists - Heritage Capitol museum, city of Space to name a couple.

To the East a must stop is **Castelnaudary** to try its delicious cassoulet, a local gastronomic specialty, before cruising on to the medieval city of Carcassonne. The streets of Trebes, whose origin date back to 4500BC, await you before reaching Homps and its man-made beaches.



Canal du Midi

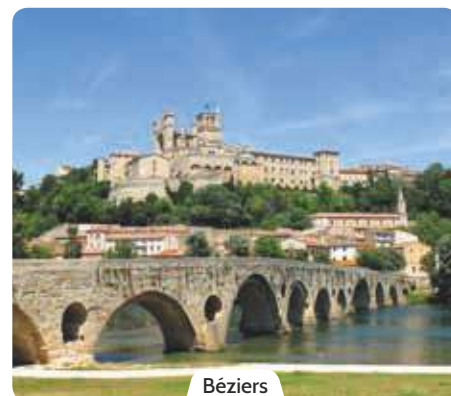

Béziers





Canal du Rhône à Sète  
Etang de Thau  
Canal du Midi

# Camargue

Aigues-Mortes

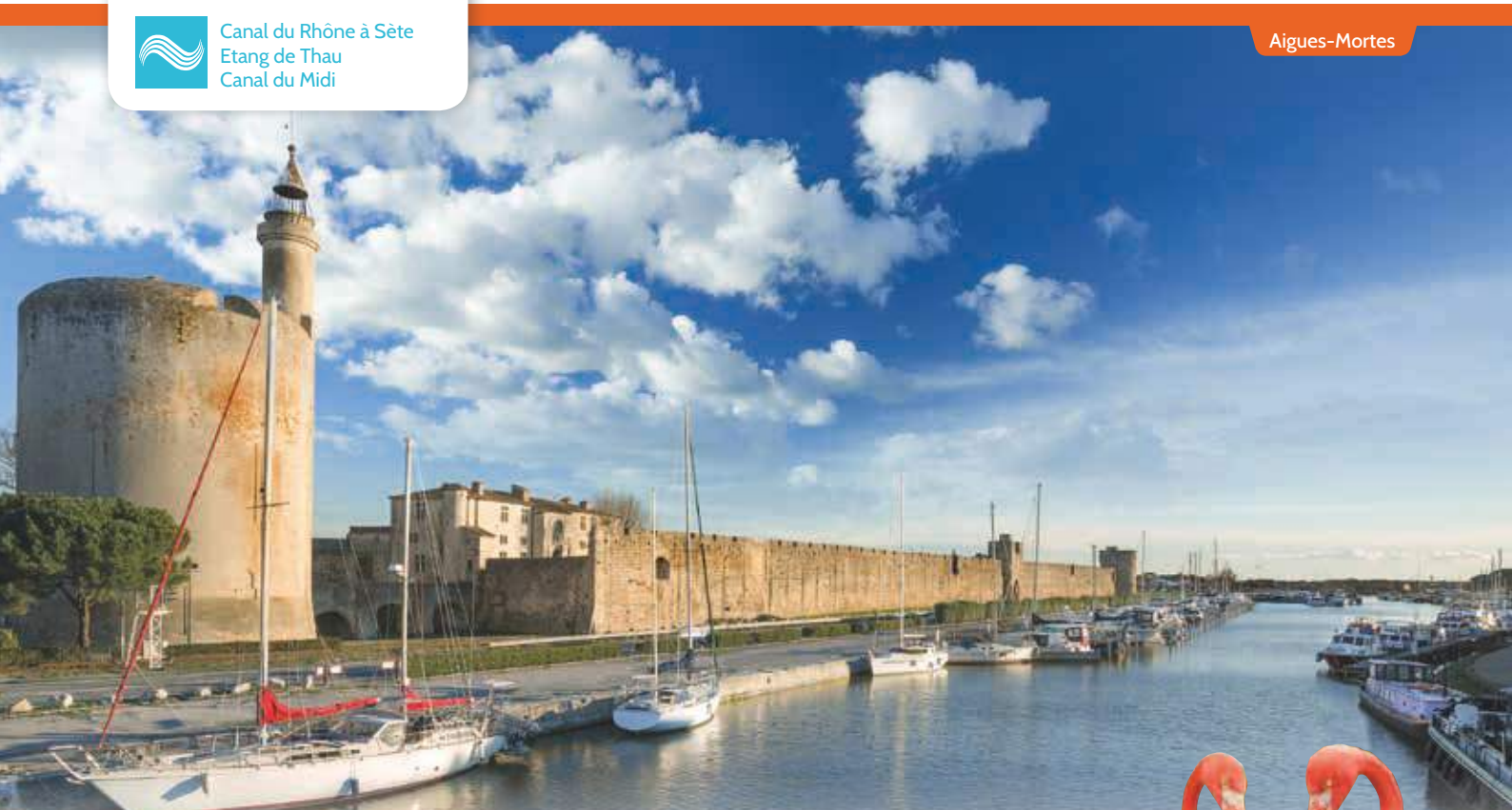

The Camargue is packed with bustling Crusader ports, sandy beaches and some of the richest flora and fauna in Europe. The south of France enjoys warm sunshine for most of the year and with only a few locks makes it ideal for first time cruisers.



## From Bellegarde

Cruise away to discover the Etang de Thau and the Camargue, land of marshes, flamingos and wild horses.

**This formidable nature reserve of 85000 hectares** has the richest fauna and flora in Europe. Remarkable settings of fortified towns, remnants of past history dating to the first Crusades, Meridional foods, Bouzigues oysters, Costières de Nimes wines or Frontignan Muscat.

## From Aigues-Mortes

Visit Aigues Mortes, the fortified medieval town from the thirteenth century and starting point of the first crusades of King Louis IX, and the famous salt marshes that have surrounded the city since the Middle Ages. Elsewhere enjoy the Mediterranean beaches at Grau du Roi, Palavas-les-Flots, Grande Motte or in Carnon. See the Camargue's wild horses and bulls and an abundance of exceptional flora and fauna. Taste the oysters from Bouzigues, savor a glass of Picpoul or Frontignan Muscat; discover the treasures of the Abbey of Maguelone or Saint-Gilles by road to visit St Jacques de Compostela. Last but not least explore the city of Sète, a maritime town set at the opening of the Etang de Thau lagoon.





Canal du Rhône à Sète



Cap d'Agde

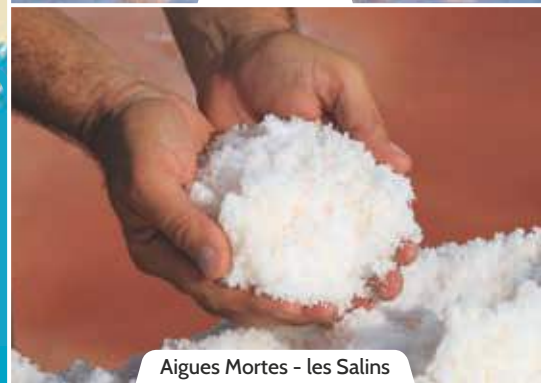

Aigues Mortes - les Salins



Aigues -Mortes - the Carbonnière Tower



Sète

**BELLEGARDE**

- Nîmes (17 km), Montpellier (66 km), Marseille (106 km), Lyon (265 km).
- A9, A54 2 Garons (12 km).
- TGV Nîmes (22 km).
- Nîmes (14 km), Montpellier (65 km).

- ESTIVALE** Duo®
- CONFORT** 900 | 1100 | 1350 VIP
- SEDAN** 1010 | 1310

DURATION	CRUISE	KM	LOCKS	HOURS
2 DAY WEEKEND	A Bellegarde > Aigues-Mortes > Bellegarde	72	-	12h
SHORT BREAK	A Bellegarde > Palavas-les-Flots > Bellegarde	122	-	15h30
1 WEEK	A Bellegarde > Etang de Thau > Bellegarde	196	-	28h

**AIGUES-MORTES**

- Nîmes (44 km), Montpellier (33 km), Marseille (136 km).
- A9 26 (20 km).
- TGV Montpellier (32 km), TGV Nîmes (42 km), TGV Avignon (1h).
- Nîmes (48 km), Montpellier (25 km), Marseille (138 km).

- ESTIVALE** Duo® | Quattro S® | Sixto® | Sixto® Prestige C | Octo®
- CONFORT** 900 DP
- SEDAN** Primo®

DURATION	CRUISE	KM	LOCKS	HOURS
2 DAY WEEKEND	A Aigues-Mortes > Bellegarde > Aigues-Mortes	72	-	12h
	B Aigues-Mortes > Grau du Roi > Palavas > Aigues Mortes	53	-	9h
SHORT BREAK	A Aigues-Mortes > Grau du Roi > Sète > Aigues-Mortes	101	-	17h
1 WEEK	A Aigues-Mortes > Grau du Roi > Etang de Thau > Agde > Vias > Aigues-Mortes	161	6	28h
1 WEEK (One way)	A Aigues-Mortes > Le Somail	139	15	27h

Boat and cruising route suggestions: non contractual information, subject to change.



Canal de Briare  
Canal latéral à La Loire  
Canal du Nivernais  
L'Yonne

# Val de Loire, Nivernais

Loire-Valley

La Charité-sur-Loire



The best bits: proximity to Paris (about 2h or 2h30 depending of the base Rogny or Plagny) ; numerous historical sites to explore, internationally renowned Sancerre wines and excellent local gastronomy. Enjoy a wide range of cruise itineraries on both canals and the river Yonne.



## From Rogny-les-Sept-Écluses and from Plagny

The Canal de Briare runs parallel to the Loire River and the superb Canal du Nivernais and offers peaceful waters alongside the rhythm of enchanting French village life. Set in surroundings between hills and forests the area is dotted with remarkable sites such as: Rogny with its seven locks built during the realm of Henry IV ; **the Briare canal bridge designed by Eiffel** ; Sancerre and pouilly, renowned for their world famous vineyards ; la Charité sur Loire (city of books) which is classified by UNESCO as a World Heritage Site and

an essential stop on the route to 'Saint-Jacques-de-Compostella' and Nevers, a town full of art, history and famous for its cathedral and gothic dukes' palace, its Roman church from the 11<sup>th</sup> century and some of the oldest potteries in France.

Lastly nature lovers should visit Bec d'Allier – the meeting point between Loire and Allier, one of the last wild rivers in Europe and classified a 'Panda Site' by the WWF.



Nevers - Ducal palace



Briare - pottery and mosaics



Briare - Eiffel canal bridge

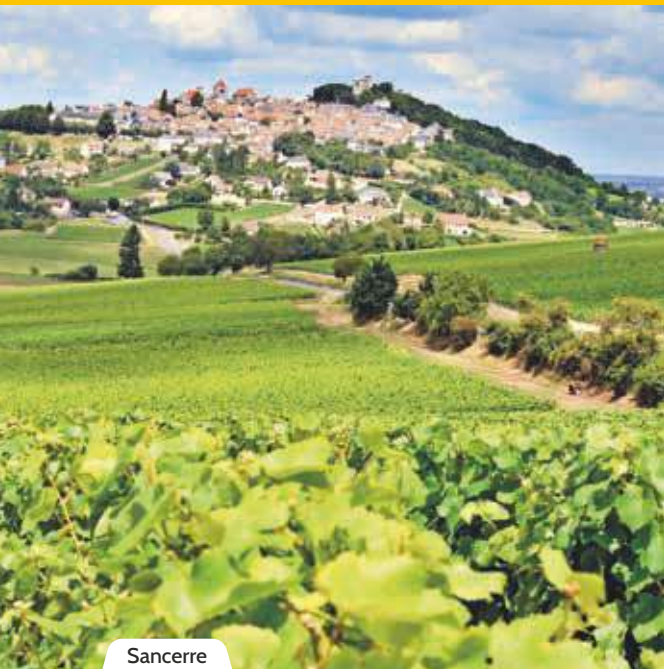

Sancerre



Guédelon - Medieval castle



## ROGNY

- Paris (155 km), Montargis (30 km), Briare (18 km).
- A77 18 Orléans - Montargis (60 km), A77 20 Orléans - Gien (23 km).
- Briare (18 km), Gien (25 km), Montargis (30 km).
- Paris-Orly (120 km).

	<b>ESTIVALE</b>	Duo®   Quattro®   Sixto® Prestige   Octo®
	<b>CONFORT</b>	900   1100   1350
	<b>SEDAN</b>	800   1000   1160   1170   1310
	<b>RIVIERA</b>	920   1120

DURATION	CRUISE	KM	LOCKS	HOURS
2 DAY	A Rogny > Châtillon-s.-Loire > Rogny	52	34	11h
WEEKEND	B Rogny > Montargis > Rogny	66	28	16h
SHORT BREAK	A Rogny > Sancerre > Rogny	120	44	26h
	B Rogny > Nemours > Rogny	132	58	34h
1 WEEK	A Rogny > La Charité-s.-Loire > Rogny	164	50	39h
	B Rogny > Moret-s.-Loing > Rogny	168	72	42h
1 WEEK (One way)	A Rogny > Sancerre > Plagny	118	32	28h
3 WEEKS (whole central loop)	A Rogny > Auxerre / Plagny > Rogny	436	174	98h

## PLAGNY

- Nevers (5 km), Bourges (90 km), Paris (250 km), Lyon (260 km).
- A6, A77, Paris (250 km - 2h30).
- Nevers (5 km).
- Paris-Orly (230 km).

	<b>ESTIVALE</b>	Duo®   Quattro®   Sixto® Prestige   Octo®
	<b>CONFORT</b>	900   1100   1350
	<b>SEDAN</b>	800   1000   1160   1170   1310
	<b>RIVIERA</b>	920   1120

DURATION	CRUISE	KM	LOCKS	HOURS
2 DAY	A Plagny > Marseilles-les-Aubigny > Plagny	46	4	8h
WEEKEND	B Plagny > Decize > Plagny	66	10	14h
SHORT BREAK	A Plagny > Sancerre > Plagny	112	22	25h
	B Plagny > Cergy-la-Tour > Plagny	102	22	25h
1 WEEK	A Plagny > Châtillon-s.-Loire > Plagny	180	32	42h
	B Plagny > Châtillon-en-Bazois > Plagny	176	54	48h
1 WEEK (One way)	A Plagny > Sancerre > Rogny	118	32	28h
3 WEEKS (whole central loop)	A Plagny > Rogny / Auxerre > Plagny	436	174	98h

Boat and cruising route suggestions: non contractual information, subject to change.



Canal de Bourgogne  
Canal du Nivernais  
L'Yonne

# Bourgogne *Burgundy*

Auxerre - Canal du Nivernais



Close to Paris (approx 2 hours by road), discover the Canal de Bourgogne - one of the best known canals in France - which winds its way through beautiful Burgundy countryside. Do not forget to discover the richness of its cultural heritage, its world famous wines and cuisine to try!



## From Briennon

Briennon is located at the crossroads of **three exceptional waterways**: the Canal de Bourgogne, the Yonne and the Canal du Nivernais.

Cliffs, groves, and waterside vineyards make up the landscape that surrounds the meandering rivers. Numerous castles, **medieval villages** and historic towns invite you to stop: Joigny, Sens, Auxerre (a city full of art and history) or Mailly-le-Château set on a rocky outcrop ...

The area is excellent for **fishing** with many species of fish populating the rivers including pike, carp, perch, bream and many more. **Climbers** can test their skills and practice climbing on the famous rocks at Saussois while wine lovers can visit cellars and **prestigious vineyards** (Châblis, Irancy, Crémant de Bourgogne...)



## From Venarey-les-Laumes

Cruising the Bourgogne canal is in itself a trip into the history of France whilst at the same time navigating one of the best known canals in the country. An exceptional number of sites and monuments border the canal. The most prestigious is incontestably **the Cistercian Abbey of Fontenay** (World Heritage of Unesco) but you will also discover a few paces away, or a short bicycle ride, imposing Burgundy castles such as Bussy, Tanlay, Ancy le Franc, Nuits, Maulne...

Prestigious world-renowned wines and excellent traditional Burgundy gastronomy await you at each bend of the canal. Our Venarey base also provides cruising itineraries to discover the Nivernais canal, and stop offs such as Auxerre with its gothic cathedral.



Saint-Bris-le-Vineux - Vineyards



Bussy Rabutin - castle



NICOLS® base  
 See p. 11

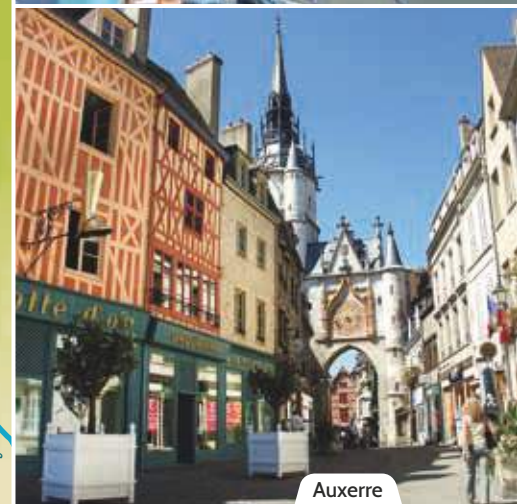

Auxerre



Fontenay abbey

## BRIENON

- Auxerre (30 km), Paris (170 km), A6, Paris-Lyon 18 Joigny (34 km).
- Laroche-Migennes (10 km).
- Laroche-Migennes (Paris - 1h20).
- Paris-Orly (150 km).

- ESTIVALE** Quattro®
- CONFORT** 900 DP | 1100 | 1350
- SEDAN** 1000 | 1150 | 1160 | Primo®
- RIVIERA** 920

DURATION	CRUISE	KM	LOCKS	HOURS
2 DAY WEEKEND	A Brienon > Joigny > Brienon	36	10	8h
	B Brienon > Saint-Florentin > Brienon	20	8	6h
SHORT BREAK	A Brienon > Villeneuve-s.-Yonne > Brienon	74	16	16h
	B Brienon > Tonnerre > Brienon	70	32	20h
	C Brienon > Auxerre > Brienon	64	22	15h
1 WEEK	A Brienon > Sens > Brienon	106	22	23h
	B Brienon > Ancy-Le-Franc > Brienon	130	62	38h
	C Brienon > Mailly-le-Château > Brienon	154	68	43h
1 WEEK (One way)	A Brienon > Saint-Florentin > Tonnerre > Montbard > Venarey	108	57	32h
3 WEEKS (The whole central loop)	A Brienon > Plagny > Rogny > Brienon	436	174	98h

## VENAREY-LES-LAUMES

- Montbard (15 km), Dijon (70 km).
- A6 (Paris - 365 km - 2h45), 23 Bierre-les-Semur (25 km).
- TGV Montbard (14 km), Les Laumes-Alésia (2 km).
- Paris-Orly (255 km), Lyon (270 km), Dijon (73 km).

- ESTIVALE** Duo® | Quattro® | Sixto® | Octo®
- CONFORT** 900 DP | 1100 | 1350
- SEDAN** 800 | 1000 | 1010 | 1160N | 1310 | Primo®
- RIVIERA** 920

DURATION	CRUISE	KM	LOCKS	HOURS
2 DAY WEEKEND	A Venarey > Buffon > Venarey	40	26	10h
SHORT BREAK	A Venarey > Ancy-le-Franc > Venarey	82	50	21h
	A Venarey > Tanlay > Venarey	124	68	31h
1 WEEK (One way)	A Venarey > Montbard > Tonnerre > Saint-Florentin > Brienon	108	57	32h
	A Venarey > Châteauneuf > Venarey	98	130	90h



Boat and cruising route suggestions: non contractual information, subject to change.



La Saône  
Canal du Rhône au Rhin  
Canal de Bourgogne  
Canal des Vosges

# Franche-Comté

La Saône

© Sara Bosmans



**A**crossroads of rivers that offer an excellent choice of cruises: the deep valley of the Doubs, the naturally charming Saône, with few locks, a fishing paradise! For the gourmets, cheese and fine Franche-Comté wines.



## From Port-sur-Saône

From here, you will navigate along **peaceful waterways, dotted with typical small villages** revealing the history of the river: Port-sur-Saône, Gallo-Roman village in the origin, Gray fascinating with its patrimonial treasures, unless you have chosen to sail on the Vosges canal to discover the densely wooded countryside of the Vosges: here you will be charmed with the calm of unspoiled nature - so don't forget your binoculars!

## From Dole

Dole, ancient capital of la Comté, doorway to the Jura and birthplace of Pasteur, situated in the heart of a marvellous region gifted with one of the most beautiful navigation areas offering a very large choice of cruising: le canal du Rhône to the Rhin (in fact it's the Doubs) with Besançon and citadel of Vauban, Baume les Dames, the charm of Comtois villages and market towns, wild beauty of fauna and flora in the superb deeply embanked valleys. You can cruise upstream one way to Port sur Saône or the Burgundy canals beyond Saint-Jean-de-Losne.

**Warning: we recommend that you've had some previous boating experience if cruising on the river Doubs.**





Canal du Rhône au Rhin

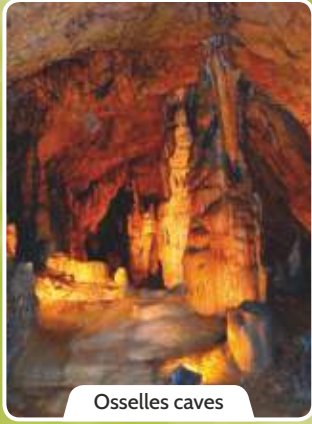

Osselles caves



Montbéliard



Dole - Acro-Isis



Gray

## PORT-SUR-SAÔNE

- Vesoul (15 km), Besançon (63 km).
- Dole (108 km), Dijon (150 km). A5 > A31 7 Langres.
- Paris (350 km, 3h45). Vesoul (15 km).
- Dijon (150 km), Bâle (150 km).

- ESTIVALE** Duo® | Quattro® | Sixto®
- CONFORT** 900 DP | 1100
- SEDAN** 1000 | 1010 | 1170 | 1310 | Primo®

DURATION	CRUISE	KM	LOCKS	HOURS
2 DAY	A Port-s.-Saône > Ray-s.-Saône > Port-s.-Saône	80	14	13h
WEEKEND	B Port-s.-Saône > Selles > Port-s.-Saône	82	16	15h
SHORT BREAK	A Port-s.-Saône > Gray > Port-s.-Saône	124	22	24h
1 WEEK	A Port-s.-Saône > Mantoche > Port-s.-Saône	158	22	26h
	B Port-s.-Saône > Bains-Les-Bains > Port-s.-Saône	118	44	28h
1 WEEK (One way)	A Port-s.-Saône > Gray > Dole	154	23	24h
10 DAYS	A Port-s.-Saône > Epinal > Port-s.-Saône	210	132	65h

## DOLE

- Besançon (55 km), Dijon (50 km).
- A36, Paris (370 km, 3h30).
- TGV Dole (1 km).
- Lyon (200 km).

- ESTIVALE** Duo® | Quattro® | Quattro S® | Sixto® | Octo®
- CONFORT** 900 DP | 1100 | 1350
- SEDAN** 1000 | 1010 | 1160N | 1170 | 1310 | Primo®
- PISCINE / POOL**

DURATION	CRUISE	KM	LOCKS	HOURS
2 DAY	A Dole > Saint-Vit > Dole	54	16	9h
WEEKEND	B Dole > Auxonne > Dole	64	20	12h
	C Dole > Saint-Jean-de-Losne > Dole	44	18	10h
SHORT BREAK	A Dole > Besançon > Dole	112	40	23h
	B Dole > Mantoche > Dole	150	24	22h
	C Dole > Verdun-sur-le-Doubs > Dole	114	18	19h30
1 WEEK	A Dole > Baume-les-Dames > Dole	182	62	37h
	B Dole > Ray-sur-Saône > Dole	250	32	40h
1 WEEK (One way)	A Dole > Gray > Port-sur-Saône	154	23	24h
2 WEEKS	A Dole > Montbéliard > Dole	294	114	68h30
	B Dole > Selles > Dole	434	60	76h



# Alsace



Canal de la Marne au Rhin  
Canal des Houillères de la Sarre  
La Moselle

Lutzelbourg



Enjoy a French boating holiday in the Alsace, a region full of history and fantastic gastronomy. The best bits : magnificent scenery - mountains and forests frame your route ; delicious regional food and wines ; watersports, cycling and hiking - something for everyone! Wonderful art and architecture in the cities...



## From Saverne and Harskirchen

Start your boating holiday from Saverne in Alsace, a land of history and gastronomy. Choose to either cruise towards Strasbourg or towards **Arzwiller** - famous for its boat lift (the only one in France).

Beyond that, you get to the green Lorraine plateau and continue your cruise to **Nancy**, stopping on route at the superb Place Stanislas, listed as a **UNESCO World Heritage Site**.

At Gondrexange you take the Canal de la Sarre which is dotted with lakes and water spots offering **beaches, swimming, and watersports**. From Harskirchen, location of our second base in Alsace (see our one way cruise option between Saverne and Harskirchen) you can cruise to Sarreguemines which is famous for its pottery or Saarbrücken which takes you just over the German border.

**European Cruise:** Enjoy a cruise through three countries! Take your boat through France, Germany and Luxembourg. Choose a three week itinerary from Saverne or two weeks if starting from Harskirchen.



Lutzelbourg valley



Strasbourg



Nancy - City Hall





Sarreguimines



Saverne

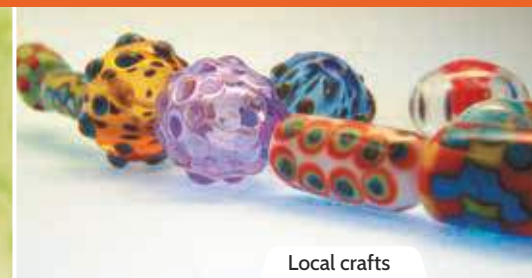

Local crafts



Animal park - Domaine Sainte-Croix



Inclined plane of Arzville

## SAVERNE

- Strasbourg (41 km).
- A4, 45, Paris (450 km - 4h15).
- TGV Paris-Strasbourg, TGV Saverne (600 m).
- Strasbourg (40 km).
- ESTIVALE** Duo® | Quattro® | Quattro® S | Sixto® | Sixto® Prestige C | Octo®
- CONFORT** 900 DP | 1350 | 1350 VIP
- SEDAN** 800 | 1000 | 1160N | 1310 | Primo®
- PISCINE / POOL**

DURATION	CRUISE	KM	LOCKS	HOURS
2 DAY WEEKEND	A Saverne > Niderviller > Saverne	44	24	12h
SHORT BREAK	A Saverne > Strasbourg > Saverne	92	40	22h
	B Saverne > Réchicourt > Saverne	92	28	20h
1 WEEK	A Saverne > Mittersheim > Saverne	122	52	32h
10 DAYS	A Saverne > Nancy > Saverne	208	66	46h30
2 WEEKS	A Saverne > Sarreguimines > Saverne	208	78	54h
	B Saverne > Nancy > Toul > Saverne	281	103	69h30
3 WEEKS	A The «European cruise»	469	97	102h30

## HARSKIRCHEN

- Sarreguimines (25 km), Saarbrücken (40 km).
- A4, 43 Sarre-Union.
- TGV Sarre-Union, (4 km).
- Strasbourg (80 km), Metz-Nancy (80 km).
- ESTIVALE** Duo® | Quattro® | Quattro® S | Sixto® | Octo®
- CONFORT** 900 DP | 1350
- SEDAN** 1010

DURATION	CRUISE	KM	LOCKS	HOURS
2 DAY WEEKEND	A Harskirchen > Sarreguimines > Harskirchen	64	20	13h30
	B Harskirchen > Pont d'Albeschaux > Harskirchen	46	32	14h
SHORT BREAK (One way)	A Harskirchen > Saverne	73	30	18h
SHORT BREAK	A Harskirchen > Réchicourt > Harskirchen	86	40	22h
	B Harskirchen > Saarbrücken > Harskirchen	108	32	21h
1 WEEK	A Harskirchen > Lützelbourg > Harskirchen	124	44	30h
2 WEEKS	A Harskirchen > Nancy > Toul > Harskirchen	273	117	68h30
	B Harskirchen > Strasbourg > Harskirchen	238	92	58h

Boat and cruising route suggestions: non contractual information, subject to change.



Germany

# Mecklenburg

Plau am See



**E**xplore green countryside and beautiful waterways!  
A quiet region with numerous cruises across lakes surrounded by rich flora and fauna.



## From Lübz

Lübz is a small town with its town centre dating back to the middle age. It's also a great starting point for navigating the area from Mecklenburg to Brandenburg through 15,000 hectares of forests and across 33 lakes covering over 54 km<sup>2</sup>. The district of Lübz enjoys the most beautiful countryside in this region of Germany.

The river Elde is navigable for 180 km and has only 17 locks. In only five hours it is possible to reach Lake Plauer - one of the largest lakes in the region. On the northern banks there is a nature reserve of 300 hectares and a paradise for those who love nature and bird life.

### EVEN MORE COMFORT ONBOARD!

The whole fleet of Lübz benefit from special equipment such as: stem propeller, quay plug 220 volts, radio / CD / MP3, bathing ladders.



Röbel

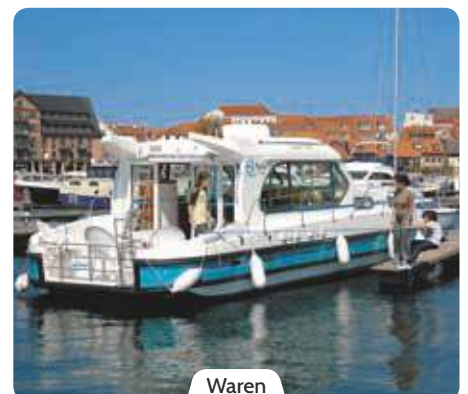

Waren



Schwerin

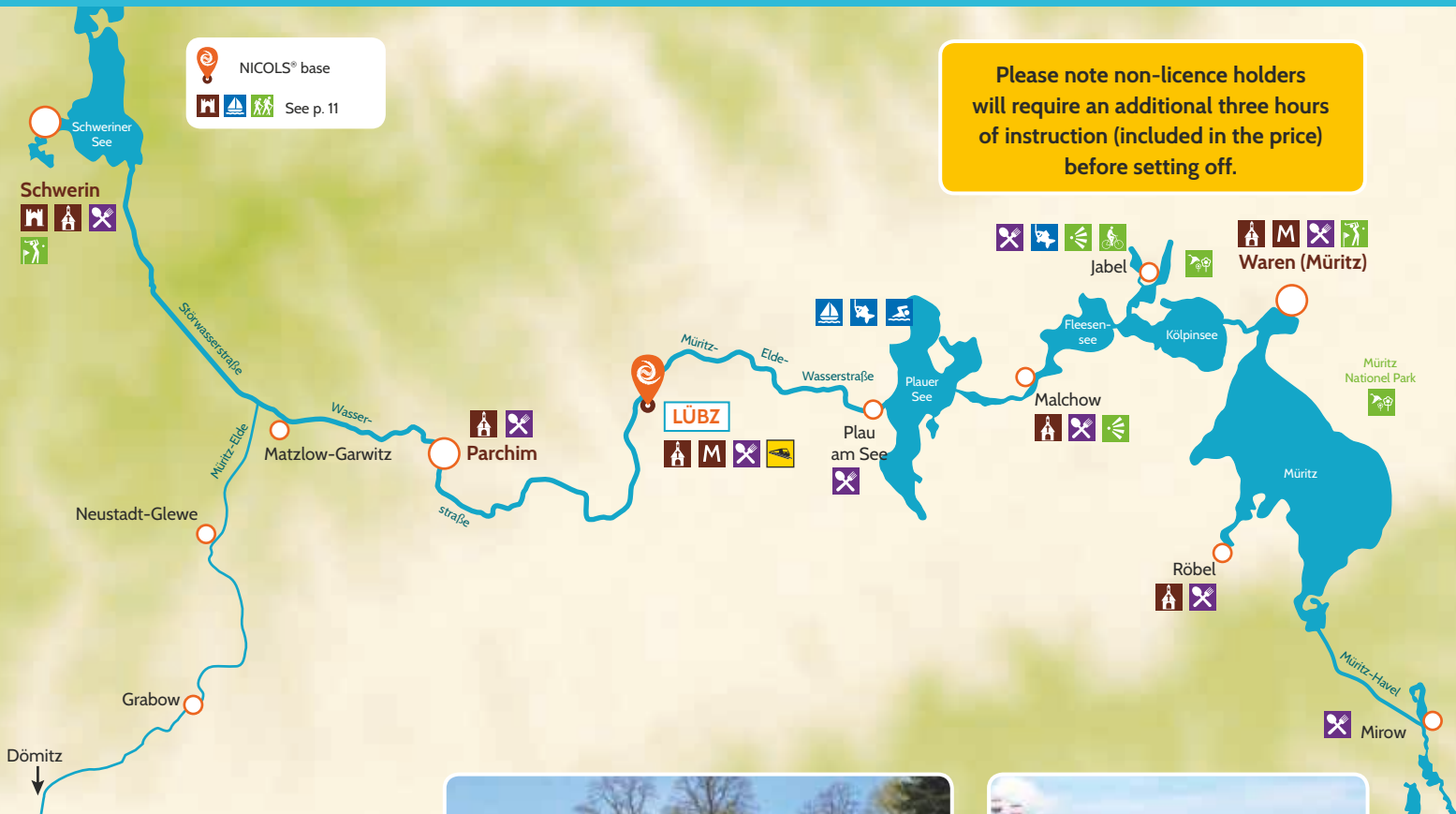

Please note non-licence holders will require an additional three hours of instruction (included in the price) before setting off.



Schwerin - Kletterwald



Waren - Müritz



Plau am See - Hubbrücke

### LÜBZ

- Schwerin (70 km).
- A24 Berlin (175 km) 16 > Parchim, A24 Hamburg (151 km) 14 > Parchim.
- Lübz (1 km).
- Hamburg (180 km), Berlin (220 km).

- ESTIVALE** Quattro®
- CONFORT** 900 DP | 1100 | 1350
- SEDAN** 1000 | 1010 | 1150 | 1160 | 1170

	DURATION	CRUISE	KM	LOCKS	HOURS
1 WEEK	A	Lübz > Röbel > Lübz	84	8	17h30
	B	Lübz > Schwerin > Lübz	149	8	26h30
	C	Lübz > Dömitz > Lübz	97	13	19h30

Boat and cruising route suggestions: non contractual information, subject to change.



Germany

# Brandenburg

Neuruppin



The Brandenburg area, famous for its nautical activities is directly linked to the Mecklenburg lakes. To the north, cruise through the “Ruppin Switzerland” following the Rhins river.



## From Neuruppin

Discover the **lake chains of crystalline waters**, joined by the canals, that wind through a landscape dotted with sheltered coves.

These heavenly waterways for nature lovers are recommended for **beginners and families**. You can combine your cruising holiday with a trip in the land of the famous writer Théodor Fontane: museums, concerts, castles, cloisters or churches - you'll discover there, a surprising cultural experience. Why not enjoy a stroll along the Neuruppin 'promenade' at Lake Neuruppin, cross wooded landscapes to Zermützel or visit the cloister mill at Lindow.

Enjoy an **amazing cultural experience** and a natural environment that will delight swimming and fishing enthusiasts!



Potsdam



**EVEN MORE COMFORT ONBOARD!**  
The whole fleet benefit from special equipment such as: stem propeller, quay plug 220 volts, radio / CD / MP3, bathing ladders.



Wustrau



Neuruppin



- NICOLS® base
- Navigation limit
- Licence necessary
- See p. 11



Oranienburg



Berlin

## NEURUPPIN

- Berlin (70 km).
- A24 Berlin (80 km), 22 Neuruppin
- Neuruppin (800 m).
- Berlin Tegel (72 km).

- ESTIVALE** Duo® | Quattro®
- CONFORT** 900 DP
- SEDAN** 1010 | Primo®

DURATION	CRUISE	KM	LOCKS	HOURS
2 DAY WEEKEND	A Neuruppin > Zermützelsee > Ruppiner See > Neuruppin	44	2	8h
	B Neuruppin > Lindow > Neuruppin	50	2	12h
SHORT BREAK	A Neuruppin > Oranienburg > Neuruppin	85	6	14h
	B Neuruppin > Werbellinsee <sup>(1)</sup> > Neuruppin	180	14	27h
1 WEEK	A Neuruppin > Berlin <sup>(1)</sup> > Potsdam > Neuruppin	170	10	23h
	B Neuruppin > Werbellinsee <sup>(1)</sup> > Neuruppin	180	14	27h

(1): Departures from Pinnow require a boat licence

Boat and cruising route suggestions: non contractual information, subject to change.

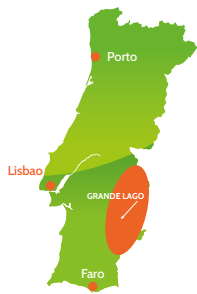

# Portugal

Lago Alqueva



Enjoy plenty of sunshine and swimming and watersports in clean warm waters. Anglers can fish for black bass, carp and more. Numerous activities await such as cycling, quad bike riding or for a slower pace of life why not discover the richness of fauna and flora, or historical interests such as fortified villages, archaeological sites and locally produced traditional handicrafts and pottery. Taste regional traditional cooking and a meal with a view at the panoramic restaurant on the port. Don't forget our Amieira team offer an 'onboard menu' and 'onboard shopping' service.



## From Amieira Marina

The region boasts waters of an incredible quality, where both nature lovers and watersports fans will find an abundance of things to see and do. Remember your camera as there are photo opportunities aplenty!

Head with your crew of family or friends to moor on an islet for a night 'Robinson Crusoe' style or venture to other stops that allow easy access to the beautiful surrounding villages and places of interest such as the Alqueva dam, an amazing structure built in 2002. Other places to visit are the new identically built village of Luz, replacing the old Luz that was swallowed up by the Lago Alqueva (don't miss the museum); **Mourão with its castle and fortifications from the 13th century; the fortified city of Monsaraz with its narrow and paved streets and a splendid bullring.**

With more than 300 sunny days per year a boating holiday on the Lago Alqueva can be enjoyed at any time of the year!



All our boats are equipped with sounders, GPS, barbecue, monitor / DVD... For rent at the base: bikes, canoes, kayaks...



Monsaraz



## DESTINATION PORTUGAL

### • OPEN ALL YEAR ROUND!

From end October 2016 to the end of March 2017  
**«PURPLE» price -5%** - Except from 17/12/2016 to  
 07/01/2017 (Christmas and New Year's Eve) : **"BLUE" price**

### • JULY SPECIAL OFFER

maintaining of the **«PALE YELLOW»** prices instead  
 of **«DARK YELLOW»** ones.

## AMIEIRA MARINA

- Evora (60 km), Lisbonne (180 km).
- A6 Lisbonne (2h), A2 Faro (2h30), IP2 Evora (45 mn).
- Lisbonne, Faro et Badajoz, Sevilla, Madrid (ESP).

	<b>ESTIVALE</b>	Duo®   Quattro®
	<b>CONFORT</b>	1100   1350
	<b>SEDAN</b>	1010   1170   1310

DURATION	CRUISE	KM	LOCKS	HOURS
2 DAY WEEKEND	A Amieira > Mourao > Amieira	88,5	-	10h
SHORT BREAK	A Amieira > Monsaraz > Amieira	163	-	18h
1 WEEK	A Amieira > Juromenha > Amieira	278	-	30h

N.B. : For car rental advice from Lisbon or Faro airports please contact us for more details.

# The Nicols story



Nicols® began boat construction back in 1986 as part of a wider French industrial group that specialised in the transformation of plastic materials.

In 1990 the first Nicols® base opened in Dole in Franche-Comté. The following year a reservation centre opened to take rental bookings for holidaymakers.

30 years later and Nicols® continue to manage the complete process: boat construction, boat hire and the managing of the bases. Over the years, different generations of boats have been created: the

Marinas, then Riviera, then the easily recognisable 'sea-yacht' shape and renowned terrace of the Sedans, the Confort range that is loved so much by couples and finally the newest Estivale range.

In total there are **five ranges, 25 boat models and nearly 600 craft that have been produced** from the Nicols® boatyard.

## Own your very own Nicols® boat



▶ **Enjoy lazy days on the water all year round**

A spacious living area, a fitted kitchen, cabins and bathrooms, a terrace...**your Nicols® boat is as comfortable as a floating home!** Such is the case for some of our clients who have enjoyed it so much, that they have chosen to buy a Nicols® river boat as their second home.

Whether new or second hand there is the possibility to have interior fittings altered or made to measure as you wish. The Nicols® boat enthusiasts are not only holidaymakers but also happy boat owners!

*For more information on buying a boat - whether new, refurbished, customised or second-hand - please contact Nicols®.*

▶ **Second hand  
Nicols® boats  
from just:**

**25.000€\***

\*Price quoted relates to a N800 Sedan.



# The Nicols fleet®

The key to a successful boating holiday is in choosing the best boat for you and your crew – from the size of the boat, its facilities and layout of cabins and internal equipment, to the security for accommodating children...

The information below will help you make your selection of boat.

## 1 Choose your range

• **ESTIVALE** range p. 42-43  
Nicols® very latest boats, high-end equipment and clever design to make the most of available space.

• **CONFORT** range p. 44-45  
Great for couples, each cabin has its own private bathroom.

• **SEDAN** range p. 46 to 49  
Ideal for families a fantastic large rear terrace level that's easily accessible from the living room.

• **RIVIERA** range p. 50-51  
first boats created by our Nicols shipyard, simple and easy to manoeuvre.



## "Home-from-home" comfort

Our boats have a vast living room with a 360° panoramic view. The kitchen includes lots of equipment and has everything you'll need: 220l fridge with a freezer compartment\*, ring-hob, oven / grill depending on boat model \* and wide work top areas.

The kitchenware is supplied as well as the bedding (sheets, duvets, pillows). Terraces are equipped with garden furniture and either a sun awning or parasol depending on the boat model.





\*\* Fridge 220l except on: Riviera range, N800 and Primo®.  
Oven: except N800.



## 2 Choose your boat

 Read our detailed boat descriptions

Example: a boat described as being a 4+2 is a boat which offers 4 beds in cabins plus 2 extra bed spaces in the converted saloon area.

BOAT		CAPACITY				
		2-4 	4-6 	6-8 	8-10 	10-12 
ESTIVALE	DUO®	•				
	QUATTRO, QUATTRO S®		•			
	SIXTO® PRESTIGE / PRESTIGE C		•			
	SIXTO®			•		
	OCTO®				•	
CONFORT	C900 / C900 DP	•				
	C1100		•			
	C1350			•		
	C1350 VIP		•			
SEDAN	PRIMO®	•				
	N800	•				
	N1000 & N1010			•		
	N1150, N1160, N1160N, N1170				•	
	N1310					•
RIVIERA	R920			•		
	R1120				•	
	R1130			•		

 The 'comfort and equipment' icon helps you choose your boats by level of luxury.

## Security first

To make moving from one end of the boat to the other safe and easy all our walkways are covered with an antislipping surface, have a hand rail and a double railing\* at a height of 60 cm (safety criteria imposed by the legislation for boats made in France). The rear terrace on the Sedan and Estivale ranges are on the same level as the living room meaning there are no stairs to negotiate going either in or out of the boat. The front terrace of the Confort range can be reached via a gangway 1 metre high moulded into the hull deck for the maximum safety.



All these criteria mean that Nicols® boats are one of the safest on the market, particularly when it comes to accommodating crews with children and/or people with reduced mobility.

\*except N800 and Primo®

# ESTIVALE

## KEY FACTS

- ▶ The very best facilities and equipment
- ▶ Two steering positions
- ▶ Beautiful living space - living room and terrace
- ▶ Front and rear terraces  
2-10 people



Quattro®



Sixto®



Sixto®



Octo®

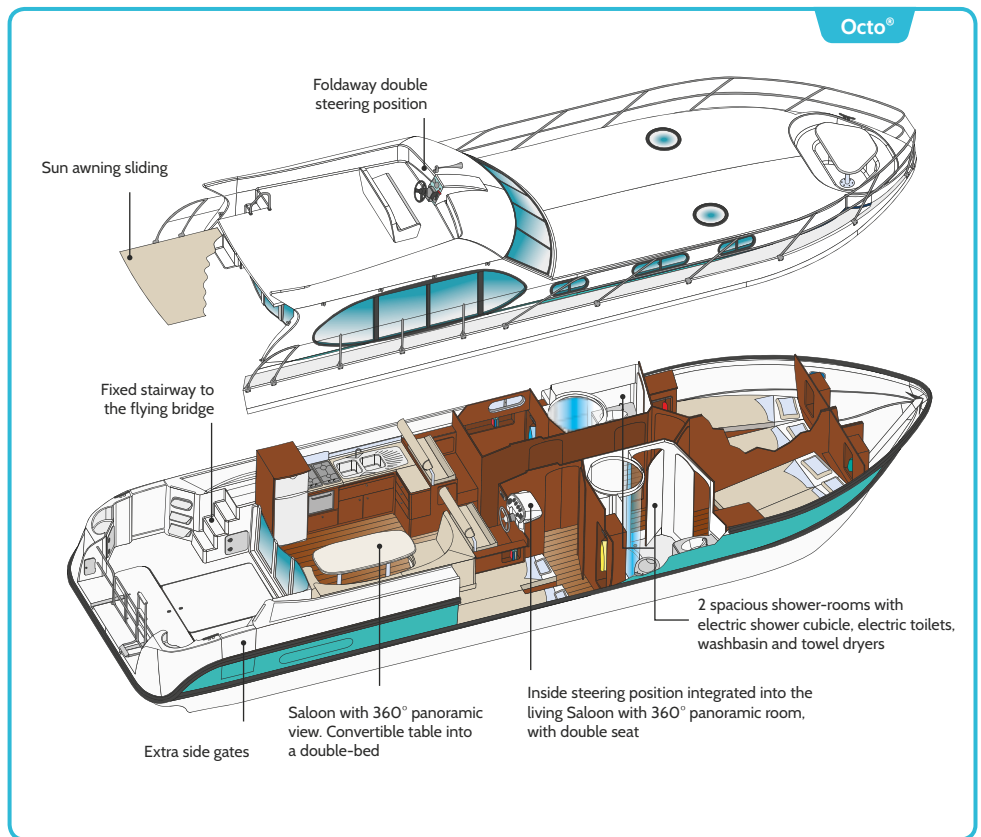

## Where can you find the Estivale Range?

	Brittany / Glénac	Brittany / Surcé-sur-Erdre	Anjou / Sablé-Sur-Sarthe	Anjou / Grez-Neuville	Charente / Sireuil	Aquitaine / Buzet	Lot / Bouziès-Saint Cirq	Midi / Le Sornail	Midi / Port-Lauragais	Carnaille / Aigues-Mortes	Carnaille / Bellegarde	Loire valley / Rogny	Nivernais / Plagny	Burgundy / Briennon	Burgundy / Venarey	Franche-Comté / Dole	Saône / Port-sur-Saône	Alsace / Harskirchen	Alsace / Saverne	Germany / Lübz	Germany / Neurruppin	Portugal / Amieira
Page	12	12	14	14	16	18	20	22	22	24	24	26	26	28	28	30	30	32	32	34	36	38
Duo®	•	•	•	•	•	•	•	•	•	•	•	•	•	•	•	•	•	•	•	•	•	•
Quattro®	•	•	•	•	•	•	•	•	•	•	•	•	•	•	•	•	•	•	•	•	•	•
Quattro S®	•																					
Sixto® Prestige																						
Sixto® Prestige C																						
Sixto®	•			•			•	•	•					•	•	•	•	•	•			
Octo®	•	•		•	•	•	•	•	•	•	•	•	•	•	•	•	•	•	•	•	•	•
Pool*					•	•		•	•							•						

\* : If renting the splash pool for a boat of 13m or more a compulsory license is required. Please contact us for details.



### DUO® :

Sleeps up to 4 people.  
Recommended for 2 adults.  
1 cabin with a double-bed + convertible table into a double-bed.

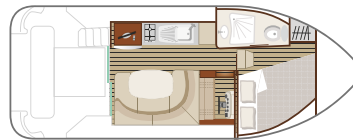

### QUATTRO® :

Sleeps up to 6 people.  
Recommended for 2 couples or 1 couple and 2 children.  
2 cabins with double-beds convertible into  
4 single-beds + convertible table into a double-bed.

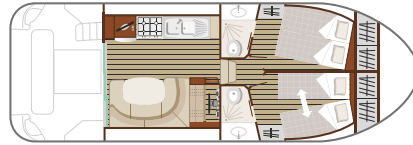

### QUATTRO® S :

Sleeps up to 6 people.  
Recommended for 2 couples or 1 couple and 2 children.  
2 cabins: 1 with double-bed + 1 cabin with double-bed convertible into 2 single-beds + convertible table into a double-bed.



### SIXTO® PRESTIGE :

Sleeps up to 6 people.  
Recommended for 2 couples or 1 couple and 2 children.  
2 cabins: 1 cabin "suite" with double-bed + 1 cabin with double-bed convertible into 2 single-beds + convertible table into a double-bed.

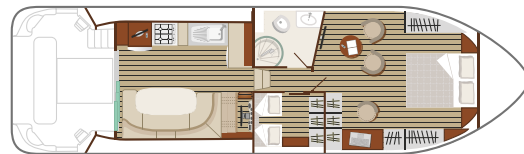

### SIXTO® PRESTIGE C :

Sleeps up to 6 people.  
Recommended for 2 couples or 1 couple and 2 children.  
2 cabins: 1 cabin with double-bed + 1 cabin with double-bed convertible into 2 single-beds + convertible table into a double-bed.



### SIXTO® :

Sleeps up to 8 people.  
Recommended for 3 couples or 2 couples with 2 children.  
3 cabins: 2 with double-beds + 1 with double-bed convertible into 2 single-beds + convertible table into a double-bed.

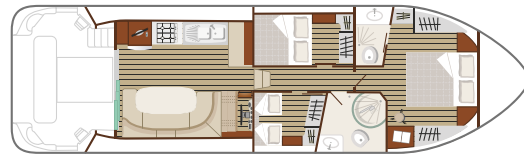

### OCTO® :

Sleeps up to 10 people.  
Recommended for 4 couples, or 2 couples with 4 children.  
4 cabins with double-beds convertible into 8 single-beds + convertible table into a double-bed.

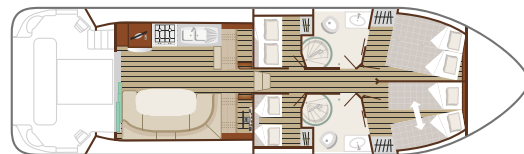

	Duo®	Quattro® / Quattro® S	Sixto® Prestige	Sixto® Prestige C	Sixto®	Octo®
Maximum capacity	4 adults	6 adults	6 adults	6 adults	8 adults	10 adults
Capacity recommended	2	4	4	4	6	8
Length / Width	8,85 x 3,40 m	10,85 x 3,80 m	13,50 x 3,80 m	13,50 x 3,80 m	13,50 x 3,80 m	13,50 x 3,80 m
Cabins	1 + saloon	2 + saloon	2 + saloon	3 + saloon	3 + saloon	4 + saloon
Double-beds (140 x 190 cm)	1 + 1 saloon	2 + 1 saloon	2 + 1 saloon	3 + 1 saloon	3 + 1 saloon	4 + 1 saloon
Single-bed (70 x 190 cm)	-	Quattro® Quattro S® 4 possible 2 possible	2 possible	2 possible	2 possible	8 possible
Bathroom / electric toilets	1	Quattro® Quattro S® 2 1	1	2	2	2
Saloon	8 m²	9 m²	11 m²	11 m²	11 m²	11 m²
Kitchen equipment						
220 L fridge (freezer)	●	●	● (195 L)	●	●	●
4 ring-hob	● (2 ring-hob)	●	●	●	●	●
Oven	● (Gril)	●	●	●	●	●
Dishwasher	-	-	●	-	-	-
Microwave	-	-	●	-	-	-
Water tank capacity	750 L	750 L	1150 L	1150 L	1150 L	1150 L
Fuel tank autonomy	20 days / 300 L	14 days / 270 L	14 days / 270 L	14 days / 270 L	14 days / 270 L	14 days / 270 L
Double steering position	●	●	●	●	●	●
Other equipment:						
Clim	-	-	-	●	-	-
Radio, CD, MP3	●	●	●	●	●	●
DVD monitor	●	●	(1 TV saloon + 1 TV cabin)	●	●	●
Electrical connector 220 V on board	●	●	●	●	●	●
Stem propeller	-	-	●	●	●	●
Garden furniture	●	●	●	●	●	●
Sun awning sliding	●	●	●	●	●	●
Bathing ladder	●	●	●	●	●	●
Shower	●	●	●	●	●	●

All photos and descriptions are non-contractual. We reserve the right to modify them without prior notice.

# CONFORT

## KEY FACTS

- ▶ Private bathroom for each cabin
- ▶ Ideal for couples
- ▶ Front and rear terraces
- ▶ 2-10 people



C900DP



C900DP



C1100

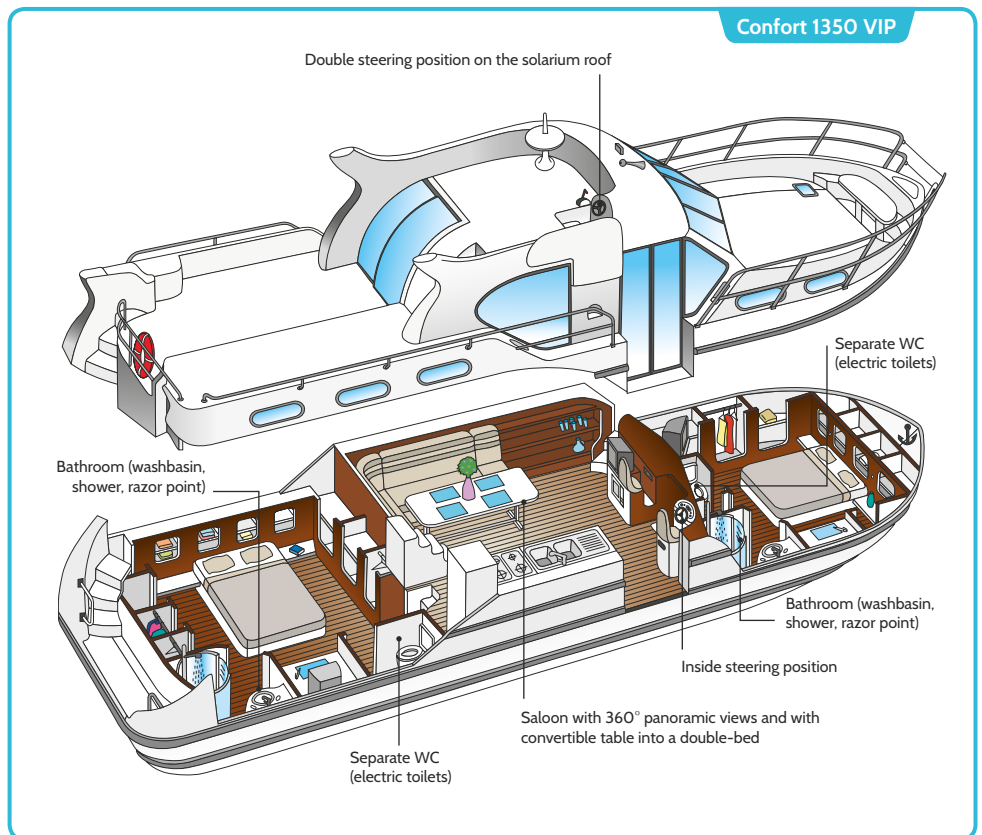

## Where can you find the Confort Range ?

Page	12	12	14	14	16	18	20	22	22	24	24	26	26	28	28	30	30	32	32	34	36	38	
Confort 900					•	•	•					•	•	•									
Confort 900 DP	•	•	•	•	•	•		•	•	•				•	•	•	•	•	•	•	•	•	
Confort 1100	•		•	•	•	•	•	•	•			•	•	•	•	•	•	•	•	•	•	•	•
Confort 1350	•		•	•			•					•	•	•	•	•		•	•	•			•
Confort 1350 VIP								•											•				
Pool*					•	•	•	•	•							•			•				

\* : If renting the splash pool for a boat of 13m or more a compulsory license is required. Please contact us for details.



C1350

**5+2**

**CONFORT 900 / 900 DP :**



Sleeps up to 7 people. Recommended for 2 couples.  
**2 cabins:** 1 with double-bed + 1 with double-bed and single-bed  
 + convertible table into a double-bed.  
**CONFORT 900 DP =** with double steering position

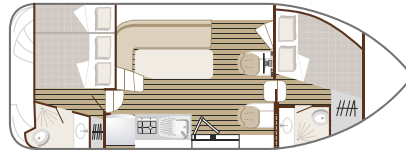

**7+2**

**CONFORT 1100 :**



Sleeps up to 9 people. Recommended for 3 couples.  
**3 cabins:** 2 with double-bed + 1 with double-bed and single-bed  
 + convertible table into a double-bed.

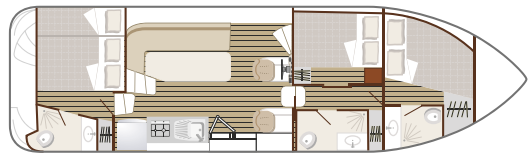

**8+2**

**CONFORT 1350 :**



Sleeps up to 10 people. Recommended for 4 couples.  
**4 cabins:** 2 with double-bed + 2 with double-beds convertible into  
 single-beds + convertible table into a double-bed.

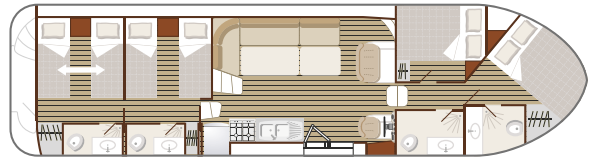

**4+2**

**CONFORT 1350 VIP :**



Sleeps up to 6 people. Recommended for 2 couples.  
**2 cabins** with double-bed + convertible table into a double-bed.

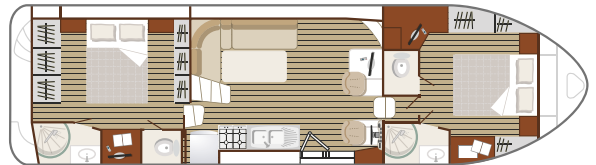

	Confort 900 / Confort 900 DP	Confort 1100	Confort 1350	Confort 1350 VIP
Maximum capacity	7 adults	9 adults	10 adults	6 adults
Capacity recommended	4	6	8	4
Length / Width	8,85 x 3,40 m	11,10 x 3,40 m	13,50 x 3,80 m	13,50 x 3,80 m
Cabins	2 + saloon	3 + saloon	4 + saloon	2 + saloon
Double-beds (140 x 190 cm)	2 + 1 saloon	3 + 1 saloon	1 saloon + 2 fixed 2 convertible into 4 single-beds	2 + 1 saloon
Single-bed (70 x 190 cm)	1	1	4 possible	-
Bathroom / WC	2	3 (electric toilets)	4 (electric toilets)	2 (electric toilets)
Saloon	9 m <sup>2</sup>	10 m <sup>2</sup>	14 m <sup>2</sup>	14 m <sup>2</sup>
Kitchen equipment				
220 L fridge (freezer)	●	●	●	●
2 ring-hob	●	●	-	-
4 ring-hob	-	-	●	●
Oven	● (Gril)	●	●	●
Microwave	-	-	-	●
Water tank capacity	800 L	1200 L	1400 L	1400 L
Fuel tank autonomy	14 days / 300 L	12 days / 300 L	20 days / 500 L	20 days / 500 L
Double steering position	C900 : - C900 DP : ●	●	●	●
Other equipment:				
Clim	-	-	-	●
Radio, CD, MP3	●	●	●	●
3 TV (depending on the reception)	-	-	-	●
Electrical connector 220 V on board	-	-	-	●
Stem propeller	-	-	-	●
Garden furniture	● (free, on request)	● (free, on request)	●	●
Bathing ladder	●	●	●	●
Shower	-	-	-	●

All photos and descriptions are non-contractual. We reserve the right to modify them without prior notice.

# SEDAN

## KEY FACTS

- ▶ Large living room & panoramic views
- ▶ Spacious rear terrace
- ▶ Ideal for families
- ▶ 2-12 people



N1000

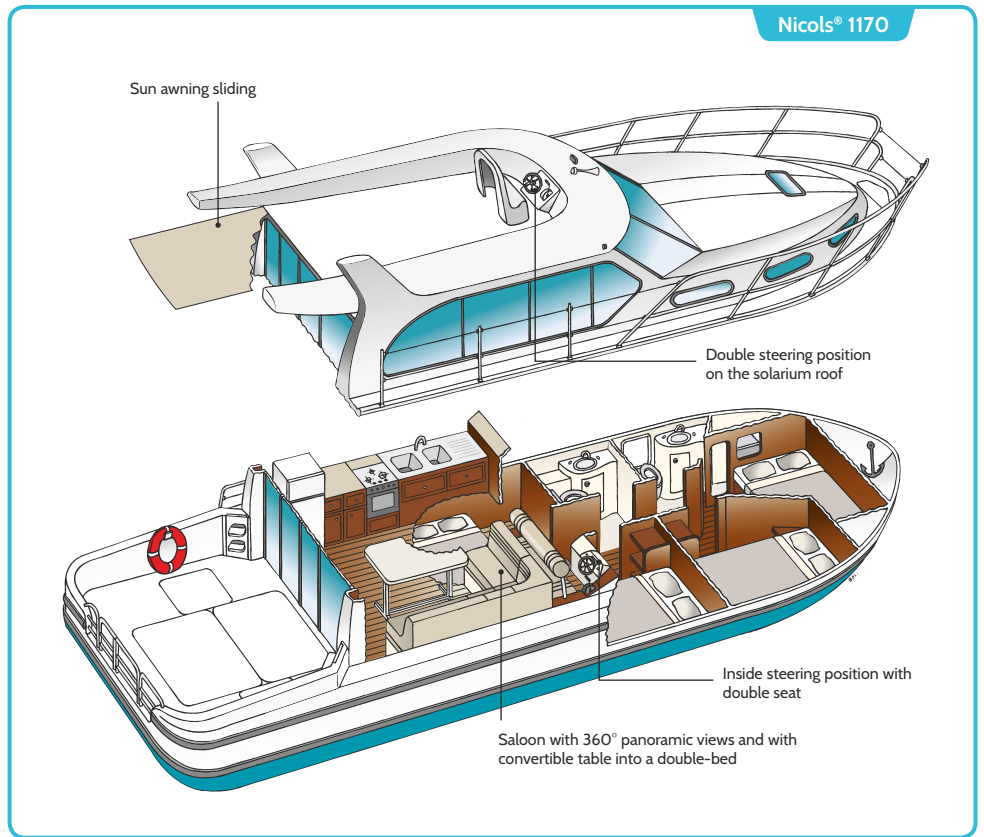

## Where can you find the Sedan Range?

	Brittany / Glénac	Brittany / Suze-sur-Erdre	Anjou / Sablé-Sur-Sarthe	Anjou / Grez-Neuville	Charente / Sireuil	Lot / Bouziès-Saint-Cirq	Aquitaine / Buzet	Midi / Le Somail	Midi / Port-Lauragais	Carnagie / Algues-Mortes	Carnagie / Bellegarde	Loire valley / Rogny	Nivernais / Plagny	Burgundy / Brienon	Burgundy / Venarey	Franche-Comté / Dole	Saône / Port-sur-Saône	Alsace / Harskirchen	Alsace / Saverne	Germany / Lübbz	Germany / Neuruppin	Portugal / Amieira
Page	12	12	14	14	16	18	20	22	22	24	24	26	26	28	28	30	30	32	32	34	36	38
Sedan 800					•			•	•			•	•		•			•				
Primo®	•		•	•	•	•	•	•	•				•	•	•	•		•			•	
Sedan 1000	•	•	•	•	•	•	•	•				•	•	•	•	•		•		•		
Sedan 1010			•			•	•					•		•	•	•				•	•	•
Pool*					•	•	•	•							•			•				

\* : Available on the Sedan range (excluding N800 & Primo®) / If renting the splash pool for a boat of 13m or more a compulsory license is required. Please contact us for details.



Primo®



Primo®



### NICOLS® 800 :

Sleeps up to 3 people (1 couple and 1 child).  
Recommended for 1 couple.  
1 cabin with double-bed + convertible table into a bed (recommended for 1 people)

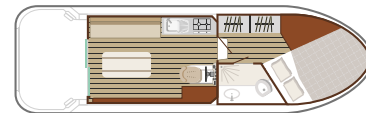

### PRIMO® :

Sleeps up to 4 people.  
Recommended for 1 couple + 2 children.  
1 cabin with double-bed + convertible table into a double-bed.

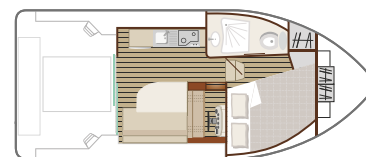

### NICOLS® 1000 :

Sleeps up to 8 people.  
Recommended for 4 adults and 2 children.  
3 cabins with double-bed + convertible table into a double-bed.

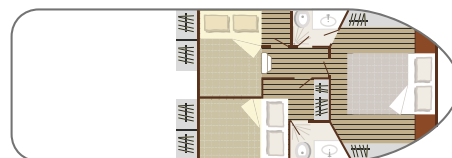

### NICOLS® 1010 :

Sleeps up to 8 people.  
Recommended for 4 adults and 2 children.  
3 cabins with double-bed + convertible table into a double-bed.

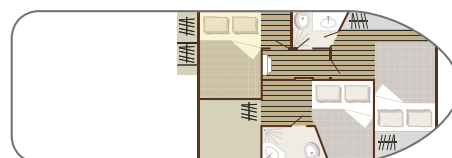

Headroom above bunks:  
100 cm maximum

Nicols® 1000 & 1010  
Deck plan:

Saloon table and seating convertible into a double-bed

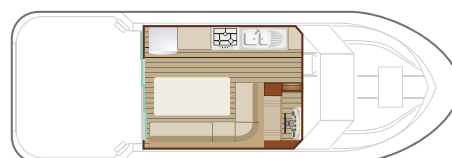

	Sedan 800	Primo®	Sedan 1000	Sedan 1010
Maximum capacity	3 adults	4 adults	8 adults	8 adults
Capacity recommended	2 adults	2 adults / 2 children	4 adults / 2 children	4 adults / 2 children
Length / Width	8 x 2,50 m	7,95 x 3,40 m	10 x 3,70 m	10 x 3,70 m
Cabins	1 + saloon	1 + saloon	3 + saloon	3 + saloon
Double-beds (140 x 190 cm)	1 + saloon	1 + 1 saloon	3 + 1 saloon	3 + saloon
Single-bed (70 x 190 cm)	-	-	-	-
Bathroom / WC	1	1	2	2
Saloon	5 m <sup>2</sup>	7 m <sup>2</sup>	10 m <sup>2</sup>	10 m <sup>2</sup>
<b>Kitchen equipment</b>				
220 L. fridge (freezer)	-	-	●	●
130 L. Fridge + freezer	-	●	-	-
56 L. Fridge	●	-	-	-
3 ring-hob	-	-	●	●
2 ring-hob	●	●	-	-
Oven	-	●	●	●
Water tank capacity	200 L	200 L	600 L	600 L
Fuel tank autonomy	10 days / 130 L	10 days / 135 L	14 days / 300 L	14 days / 300 L
Double steering position	-	-	●	●
<b>Other equipment:</b>				
Radio, CD, MP3	●	●	●	●
Electrical connector 220 V on board	-	●	-	-
Garden furniture	● (free, on request)	● (free, on request)	●	●
Sun awning sliding	-	-	●	●
Bathing ladder	●	●	●	●

All photos and descriptions are non-contractual.  
We reserve the right to modify them without prior notice.



### NICOLS® 1150 :

Sleeps up to 10 people.  
Recommended for 4 adults and 4 children.  
4 cabins with double-bed + convertible table into a double-bed.

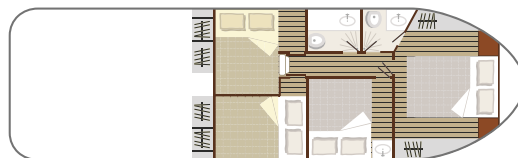

### NICOLS® 1160 / 1160N :

Sleeps up to 10 people.  
Recommended for 4 adults and 4 children.  
3 cabins with double-bed + 1 cabin with bunk bed + convertible table into a double-bed.

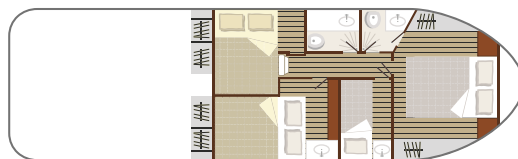

*Nicols® 1160 (2 bathrooms + 2 washbasins)- Nicols® 1160N (2 bathrooms)*



### NICOLS® 1170 :

Sleeps up to 10 people.  
Recommended for 4 adults and 4 children.  
4 cabins with double-bed + convertible table into a double-bed.

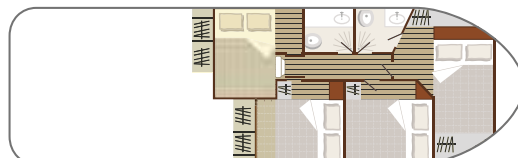

### NICOLS® 1310 :

Sleeps up to 12 people.  
Recommended for 6 adults and 4 children.  
5 cabins with double-bed + convertible table into a double-bed.

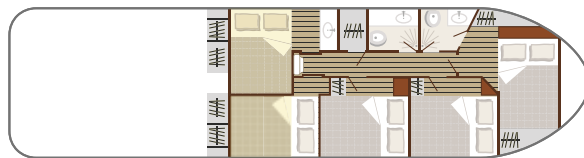

Headroom above bunks: 100 cm maximum

▼ Nicols® 1170 - 1160 - 1160N & 1150  
Deck plan: Saloon table and seating convertible into a double-bed

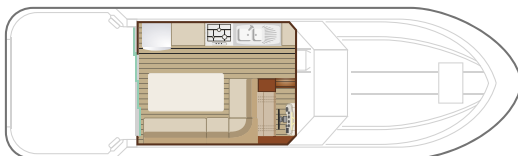

▼ Nicols® 1310  
Deck plan: Saloon table and seating convertible into a double-bed

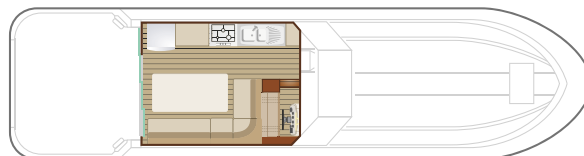

	Sedan 1150	Sedan 1160 / 1160N	Sedan 1170	Sedan 1310
Maximum capacity	10 adults	10 adults	10 adults	12 adults
Capacity recommended	4 adults / 4 children	4 adults / 4 children	4 adults / 4 children	6 adults / 4 children
Length / Width	11,50 x 3,70 m	11,50 x 3,70 m	11,50 x 3,70 m	13 x 3,70 m
Cabins	4 + saloon	4 + saloon	4 + saloon	5 + saloon
Double-beds (140 x 190 cm)	4 + 1 saloon	3 + 1 saloon	4 + 1 saloon	5 + 1 saloon
Single-bed (70 x 190 cm)	-	2	-	-
Bathroom / WC	2	2	2	2
Saloon	10 m <sup>2</sup>	10 m <sup>2</sup>	10 m <sup>2</sup>	10 m <sup>2</sup>
<b>Kitchen equipment</b>				
220 L fridge (freezer)	●	●	●	●
3 ring-hob	●	●	●	●
Oven	●	●	●	●
<b>Water tank capacity</b>	750 L	750 L	750 L	900 L
<b>Fuel tank autonomy</b>	12 days / 300 L	12 days / 300 L	12 days / 300 L	10 days / 300 L
<b>Double steering position</b>	●	●	●	●
<b>Other equipment:</b>				
Radio, CD, MP3	●	●	●	●
Electrical connector 220 V on board	-	(N1160N only)	-	-
Garden furniture	●	●	●	●
Sun awning sliding	●	●	●	●
Bathing ladder	●	●	●	●





## Where can you find the Sedan Range?

	Brittany / Glénac	Brittany / Sucé-sur-Erdre	Aijou / Sablé-sur-Sarthe	Aijou / Grez-Neuville	Charente / Sireuil	Lot / Bouziès-Saint Cirq	Aquitaine / Buzet	Midi / Le Somail	Midi / Port-Lauragais	Camargue / Aigues-Mortes	Camargue / Bellegarde	Loire valley / Rogny	Nivernais / Plagny	Burgundy / Briennon	Burgundy / Venarey	Franche-Comté / Dole	Saône / Port-sur-Saône	Alsace / Harskirchen	Alsace / Saverne	Germany / Lüz	Germany / Neuruppin	Portugal / Amieira	
Page	12	12	14	14	16	18	20	22	22	24	24	26	26	28	28	30	30	32	32	34	36	38	
Sedan 1150																							
Sedan 1160/116ON			•		•																		
Sedan 1170	•	•	•	•		•		•	•			•	•		•	•				•			•
Sedan 1310	•		•					•	•		•	•			•	•							•
Pool*					•		•	•	•						•				•				

\*: Available on the Sedan range (excluding N800 & Primo®) / If renting the splash pool for a boat of 13m or more a compulsory license is required. Please contact us for details.

All photos and descriptions are non-contractual. We reserve the right to modify them without prior notice.

# RIVIERA

## KEY FACTS

- ▶ Charming traditional barges
- ▶ Easy handling
- ▶ Ideal for a first cruise
- ▶ 4-10 people



R920

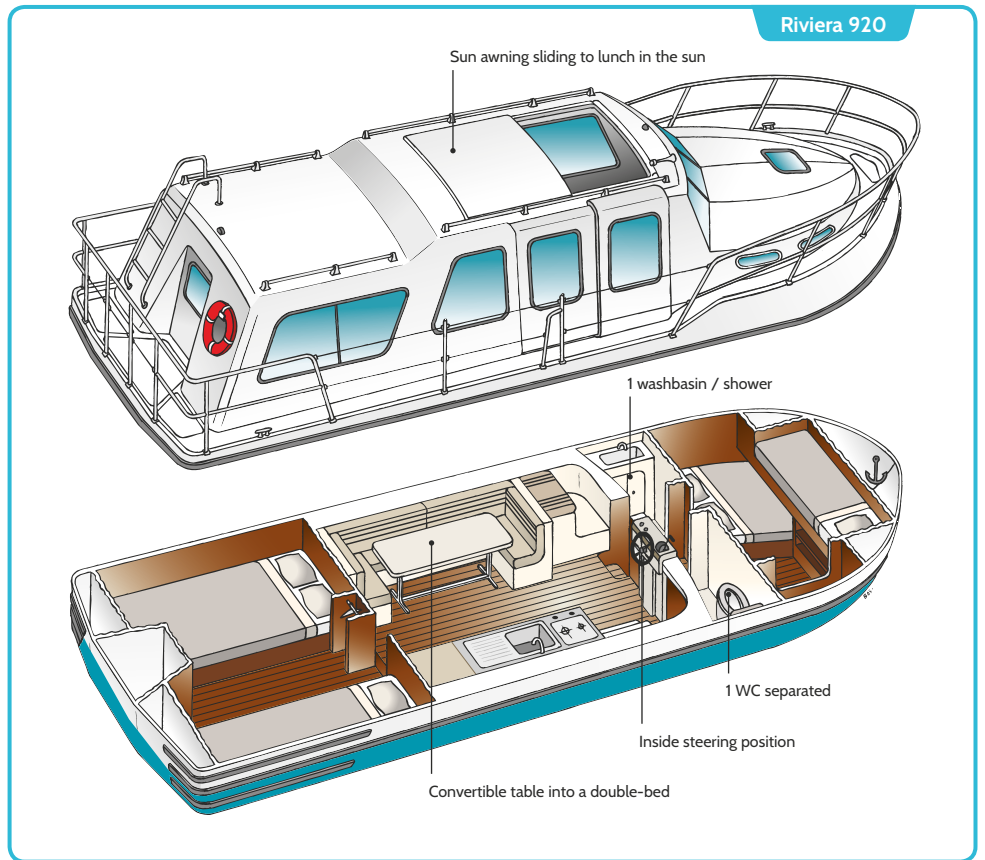

## Where can you find the Riviera Range?

Page	12	12	14	14	16	18	20	22	22	24	24	26	26	28	28	30	30	32	32	34	36	38	
Riviera 920	•	•			•	•	•	•	•			•	•	•	•								
Riviera 1120												•	•										
Riviera 1130			•				•																



### RIVIERA 920 :

Sleeps up to 8 people.  
Recommended for 5 adults.  
2 cabins with double-bed and single-bed + convertible table into a double-bed.

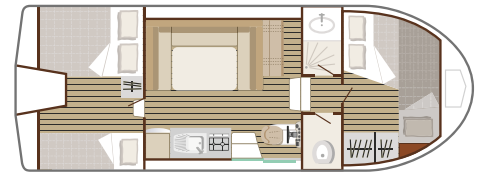

### RIVIERA 1130 :

Sleeps up to 9 people.  
Recommended for 6 adults.  
3 cabins: 1 cabin with a double-bed + a single-bed + 1 cabin with a doublebed + 1 cabin with 2 single-beds + convertible table into a double-bed.

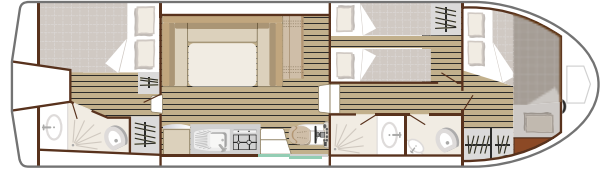

### RIVIERA 1120 :

Sleeps up to 10 people.  
Recommended for 7 adults.  
3 cabins: 2 cabins with a double-bed and a single-bed + 1 cabin with 2 single-beds + convertible table into a double-bed.

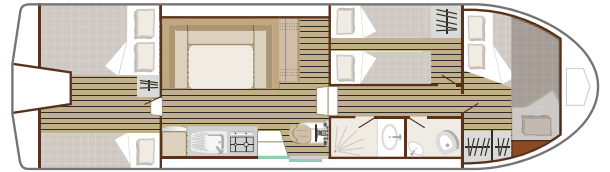

	Riviera 920	Riviera 1130	Riviera 1120
Maximum capacity	8 adults	9 adults	10 adults
Capacity recommended	5 adults	6 adults	7 adults
Length / Width	9,20 x 3,40 m	11,20 x 3,40 m	11,20 x 3,40 m
Cabins	2 + saloon	3 + saloon	3 + saloon
Double-beds (140 x 190 cm)	2 + 1 saloon	2 + 1 saloon	2 + 1 saloon
Single-bed (70 x 190 cm)	2	3	4
Bathroom / WC	1 / 1	1 + 1 / 1	1 / 1
Saloon	8 m <sup>2</sup>	9 m <sup>2</sup>	9 m <sup>2</sup>
Kitchen equipment			
Frigo 100 L	•	•	•
2 ring-hob	•	•	•
Oven	•	•	•
Water tank capacity	380 L	580 L	580 L
Fuel tank autonomy	12 days / 180 L	10 days / 180 L	10 days / 180 L
Double steering position	-	-	-
Other equipment:			
Radio, CD, MP3	•	•	•
Bathing ladder	•	•	•

All photos and descriptions are non-contractual. We reserve the right to modify them without prior notice.

## Set sail with Nicols® !



# Cruise on Europe's most beautiful waterways!

## ▶ France

### BRITTANY

Glénac & Sucé-sur-Erdre

### ANJOU

Grez-Neuville, Sablé-sur-Sarthe & Laval

### CHARENTE

Sireuil

### LOT

Bouziès/Saint-Cirq-Lapopie

### AQUITAINE

Buzet-sur-Baïse

### MIDI

Port-Lauragais & Le Somail

### CAMARGUE

Aigues-Mortes & Bellegarde

### LOIRE-VALLEY, NIVERNAIS

Rogny & Plagny

### BURGUNDY

Brienon & Venarey-Les-Laumes

### FRANCHE COMTÉ, LA SAÔNE

Port-sur-Saône & Dole

### ALSACE

Saverne & Harskirchen



## ▶ Germany

### MECKLENBURG

Lübz

### BRANDENBURG

Neuruppin



## ▶ Portugal

### LAGO ALQUEVA

Amieira Marina



Self-drive boating holidays - no experience needed

